

## RTWM-601 ANDREWS

Cylindrical roller thrust bearings

TYPE: Roller bearings, Thrust roller bearing, Cylindrical, Single direction, separable, cylindrical rollers, inch sizes, self-aligning

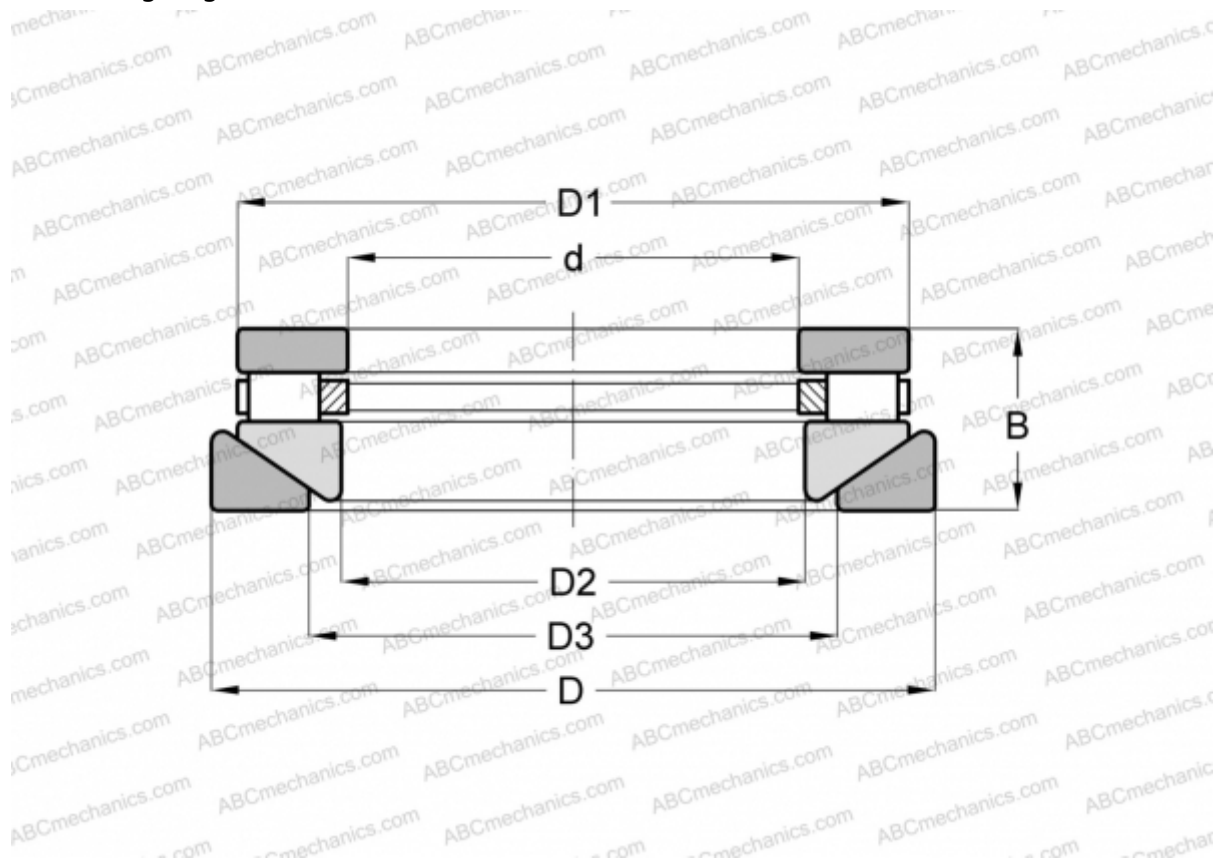

### Technical specification

#### DIMENSIONS, MM

d	25,400
D	57,150
D1	50,800
D2	28,702
D3	33,338
B	26,988

**WEIGHT, KG** 0,318

**MANUFACTURER** [ANDREWS](#)

#### INTERCHANGE

ROLLWAY	<a href="#">AT-601</a>
INA	<a href="#">RTW-601</a>