

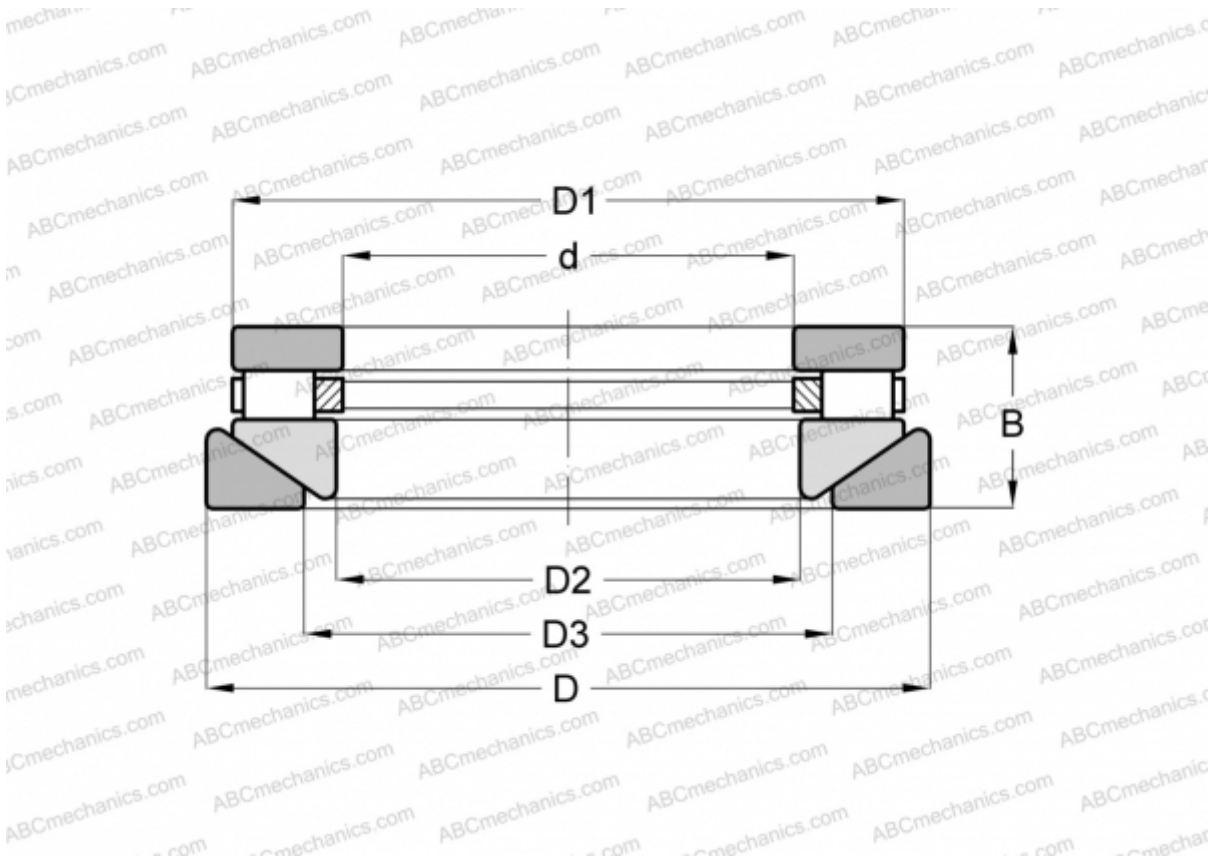

# AT-605 ROLLWAY

Cylindrical roller thrust bearings

TYPE: Roller bearings, Thrust roller bearing, Cylindrical, Single direction, separable, cylindrical rollers, inch sizes, self-aligning



## Technical specification

DIMENSIONS, MM	
d	31,750
D	63,500
D1	58,738
D2	34,925
D3	38,100
B	26,988
WEIGHT, KG	
	0,363
MANUFACTURER	
	<a href="#">ROLLWAY</a>
INTERCHANGE	
ANDREWS	<a href="#">RTWM-605</a>
INA	<a href="#">RTW-605</a>

