

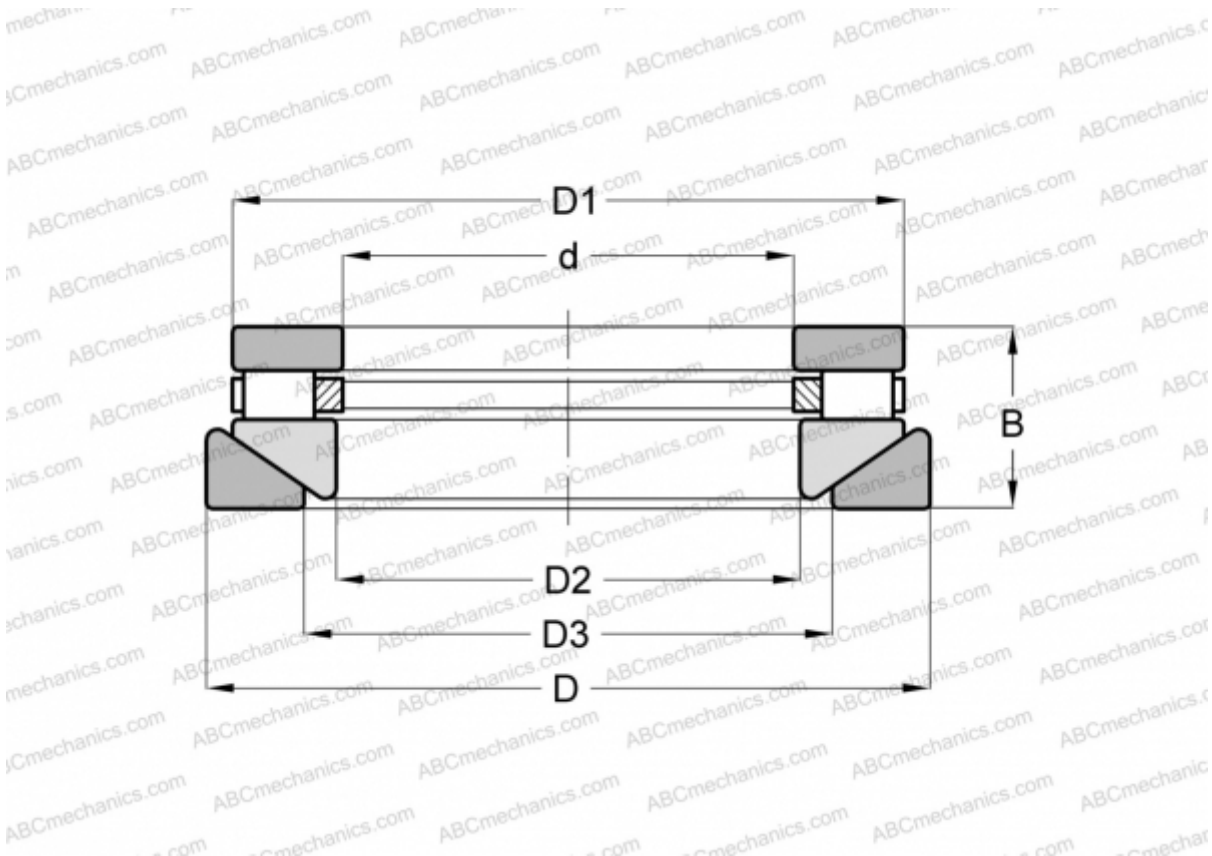

AT-607 ROLLWAY

Cylindrical roller thrust bearings

TYPE: Roller bearings, Thrust roller bearing, Cylindrical, Single direction, separable, cylindrical rollers, inch sizes, self-aligning



Technical specification

DIMENSIONS, MM	
d	34,925
D	76,200
D1	71,041
D2	38,100
D3	46,038
B	26,988
WEIGHT, KG	
0,590	
MANUFACTURER	
<a href="#">ROLLWAY</a>	
INTERCHANGE	
ANDREWS	<a href="#">RTWM-607</a>
INA	<a href="#">RTW-607</a>

