

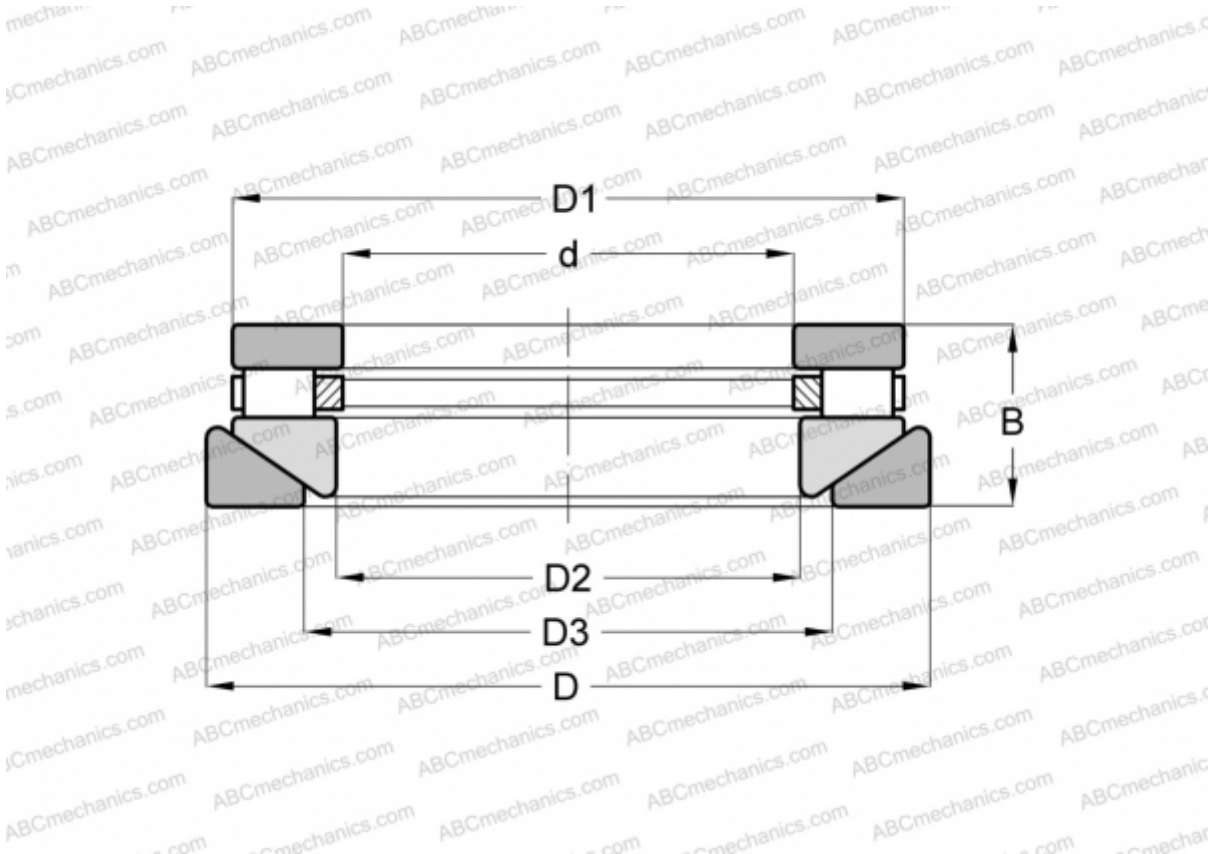

RTWM-607 ANDREWS

Cylindrical roller thrust bearings

TYPE: Roller bearings, Thrust roller bearing, Cylindrical, Single direction, separable, cylindrical rollers, inch sizes, self-aligning



Technical specification

DIMENSIONS, MM	
d	34,925
D	76,200
D1	71,041
D2	38,100
D3	46,038
B	26,988
WEIGHT, KG	
0,590	
MANUFACTURER	
ANDREWS	
INTERCHANGE	
ROLLWAY	AT-607
INA	RTW-607

