

## AT-608 ROLLWAY

Cylindrical roller thrust bearings

TYPE: Roller bearings, Thrust roller bearing, Cylindrical, Single direction, separable, cylindrical rollers, inch sizes, self-aligning

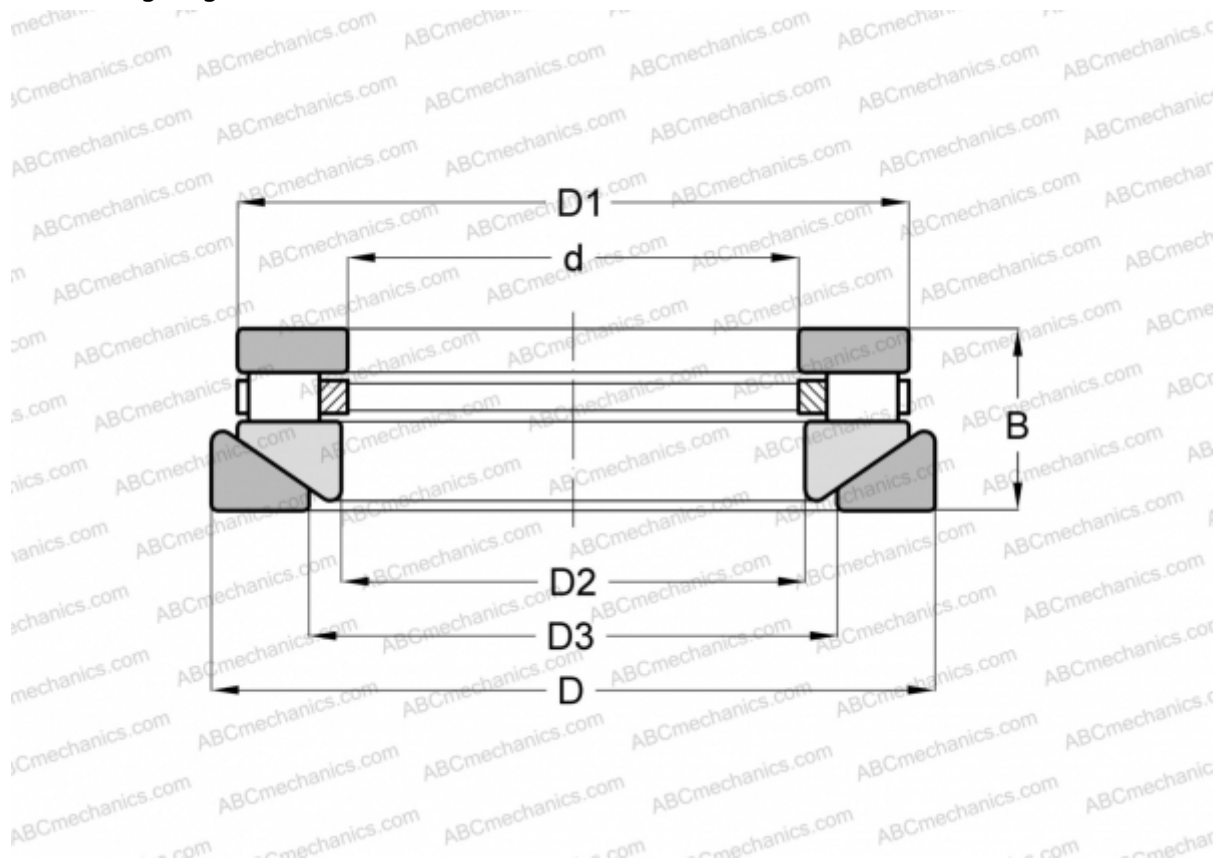

### Technical specification

#### DIMENSIONS, MM

d	36,513
D	76,200
D1	71,041
D2	38,100
D3	46,038
B	26,988

**WEIGHT, KG** 0,590

**MANUFACTURER** [ROLLWAY](#)

#### INTERCHANGE

ANDREWS	<a href="#">RTWM-608</a>
INA	<a href="#">RTW-608</a>