

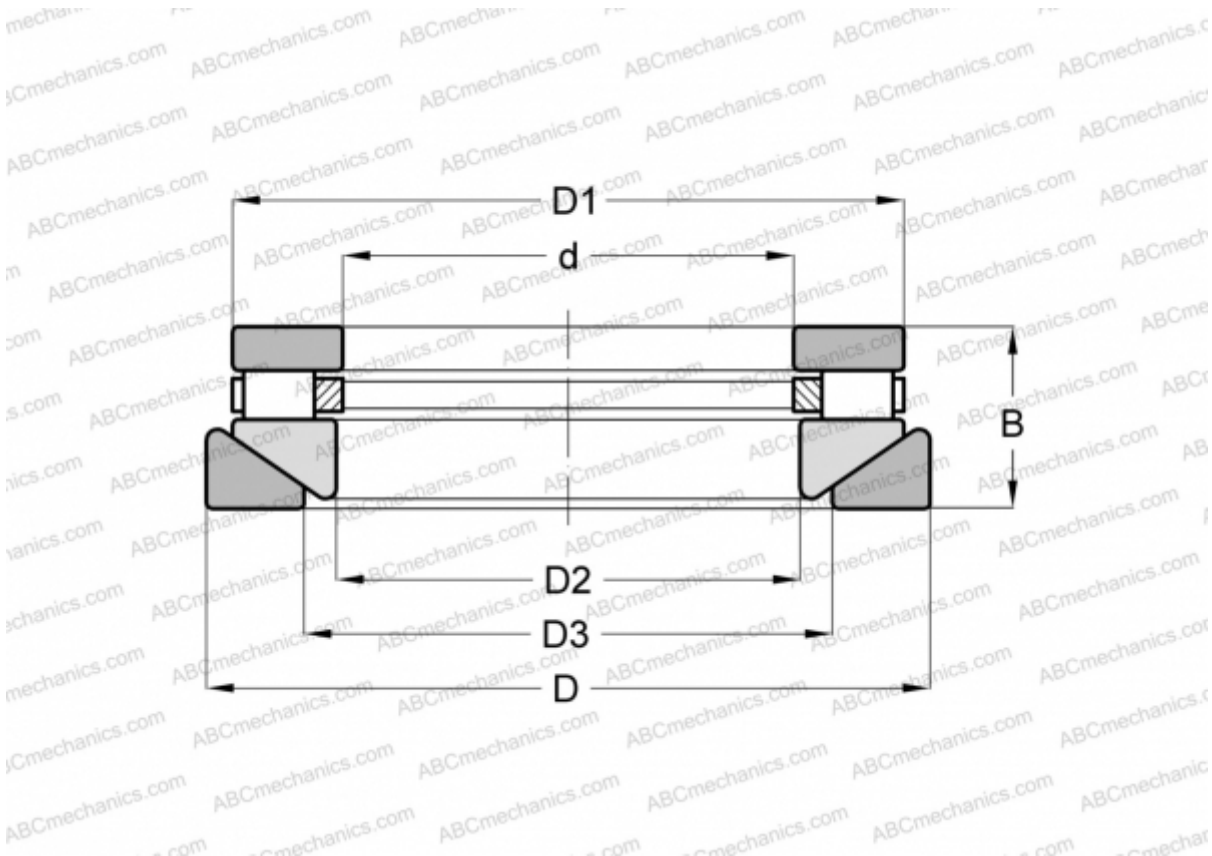

RTWM-610 ANDREWS

Cylindrical roller thrust bearings

TYPE: Roller bearings, Thrust roller bearing, Cylindrical, Single direction, separable, cylindrical rollers, inch sizes, self-aligning



Technical specification

DIMENSIONS, MM	
d	39,688
D	79,375
D1	73,818
D2	41,275
D3	47,625
B	26,988
WEIGHT, KG	
	0,635
MANUFACTURER	
	ANDREWS
INTERCHANGE	
ROLLWAY	AT-610
INA	RTW-610

