

AT-611 ROLLWAY

Cylindrical roller thrust bearings

TYPE: Roller bearings, Thrust roller bearing, Cylindrical, Single direction, separable, cylindrical rollers, inch sizes, self-aligning

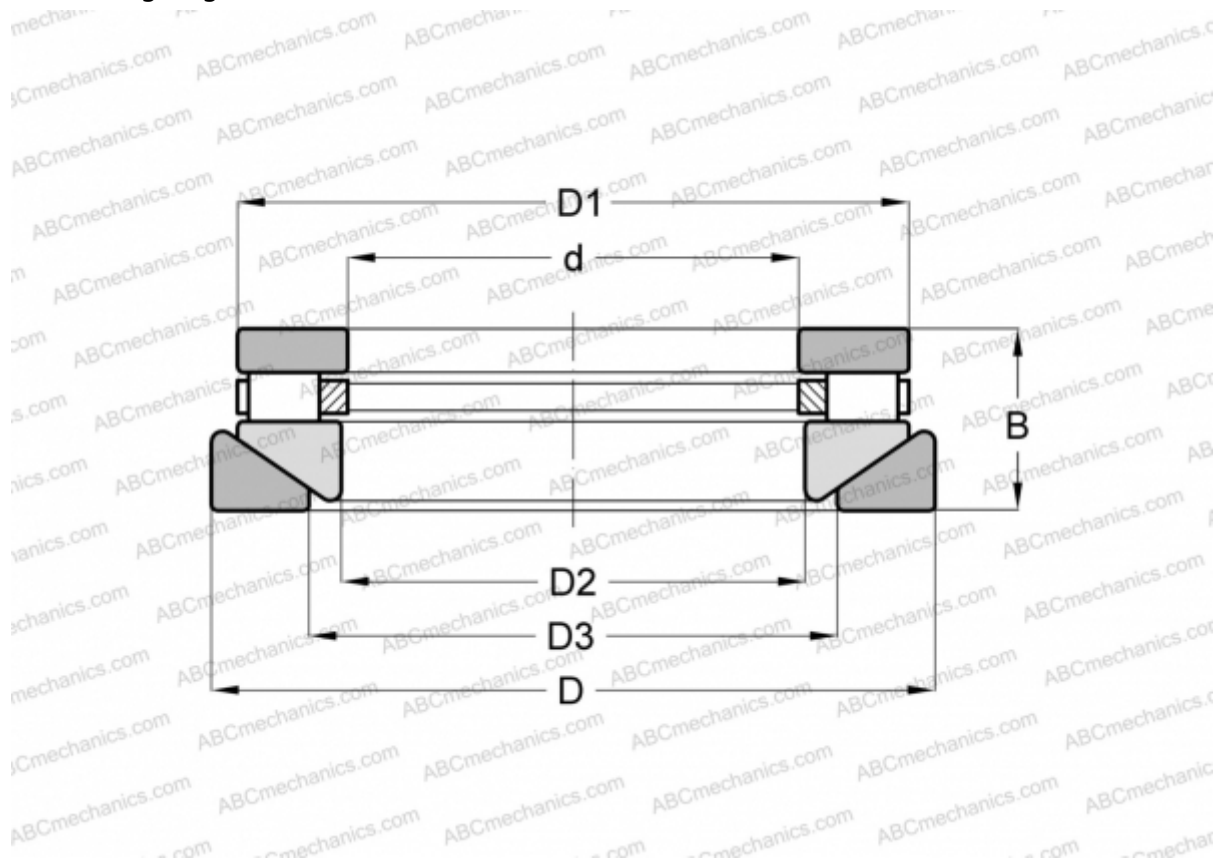

Technical specification

DIMENSIONS, MM

d	41,275
D	85,725
D1	80,168
D2	44,450
D3	50,800
B	33,338

WEIGHT, KG 0,907

MANUFACTURER [ROLLWAY](#)

INTERCHANGE

ANDREWS	RTWM-611
INA	RTW-611