

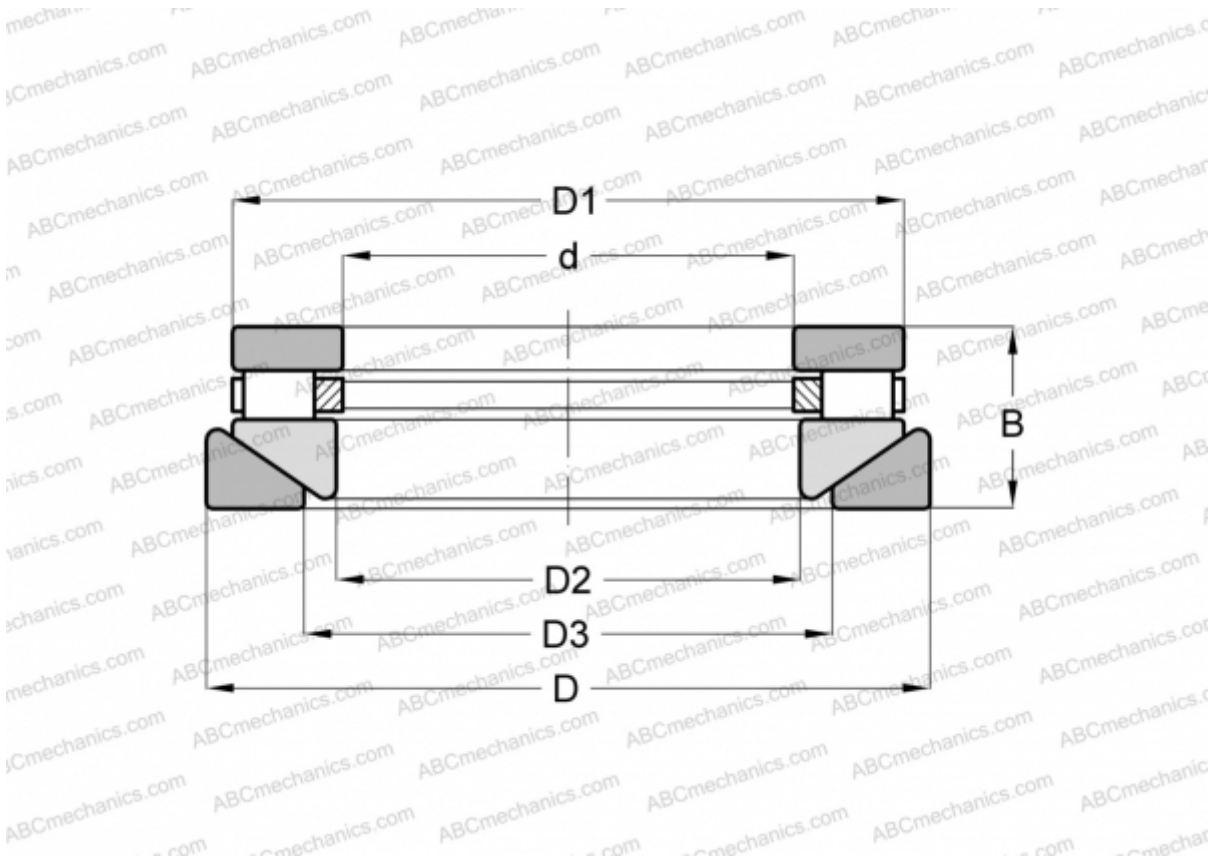

AT-612 ROLLWAY

Cylindrical roller thrust bearings

TYPE: Roller bearings, Thrust roller bearing, Cylindrical, Single direction, separable, cylindrical rollers, inch sizes, self-aligning



Technical specification

DIMENSIONS, MM	
d	42,863
D	85,725
D1	80,168
D2	44,450
D3	50,800
B	33,338
WEIGHT, KG	
	0,907
MANUFACTURER	
	ROLLWAY
INTERCHANGE	
ANDREWS	RTWM-612
INA	RTW-612

