

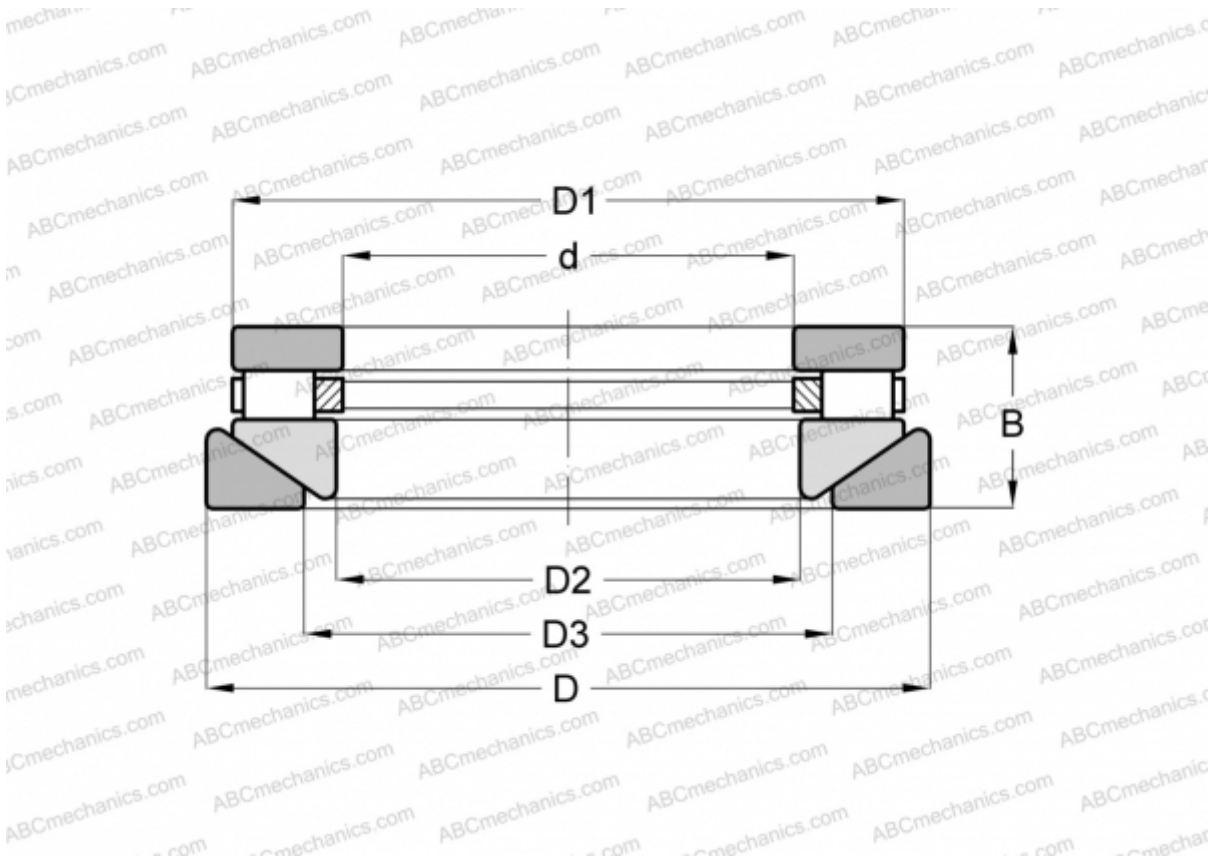

AT-613 ROLLWAY

Cylindrical roller thrust bearings

TYPE: Roller bearings, Thrust roller bearing, Cylindrical, Single direction, separable, cylindrical rollers, inch sizes, self-aligning



Technical specification

DIMENSIONS, MM	
d	44,450
D	88,900
D1	83,820
D2	47,625
D3	52,388
B	33,338
WEIGHT, KG	
	0,907
MANUFACTURER	
	ROLLWAY
INTERCHANGE	
ANDREWS	RTWM-613
INA	RTW-613

