

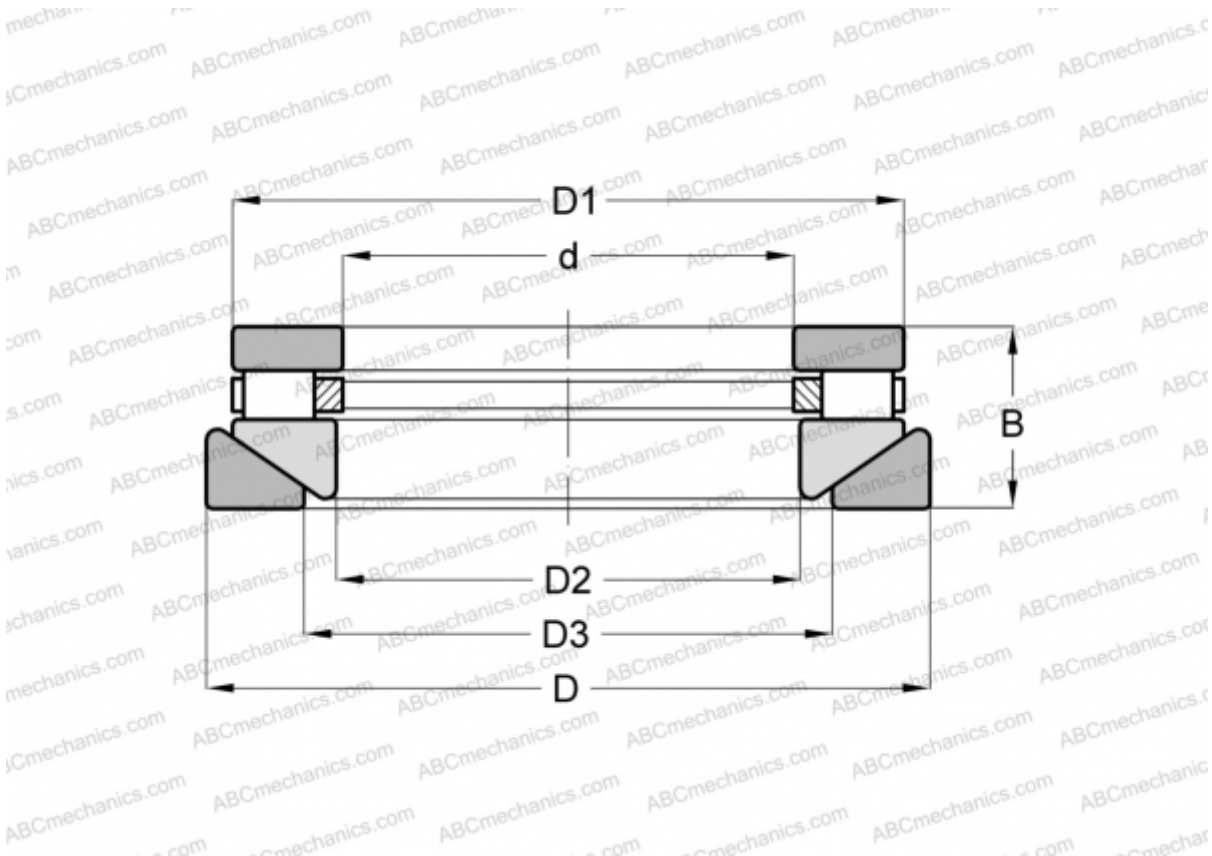

AT-615 ROLLWAY

Cylindrical roller thrust bearings

TYPE: Roller bearings, Thrust roller bearing, Cylindrical, Single direction, separable, cylindrical rollers, inch sizes, self-aligning



Technical specification

DIMENSIONS, MM	
d	47,625
D	92,075
D1	86,518
D2	50,800
D3	57,150
B	33,338
WEIGHT, KG	
	0,998
MANUFACTURER	
	ROLLWAY
INTERCHANGE	
ANDREWS	RTWM-615
INA	RTW-615

