

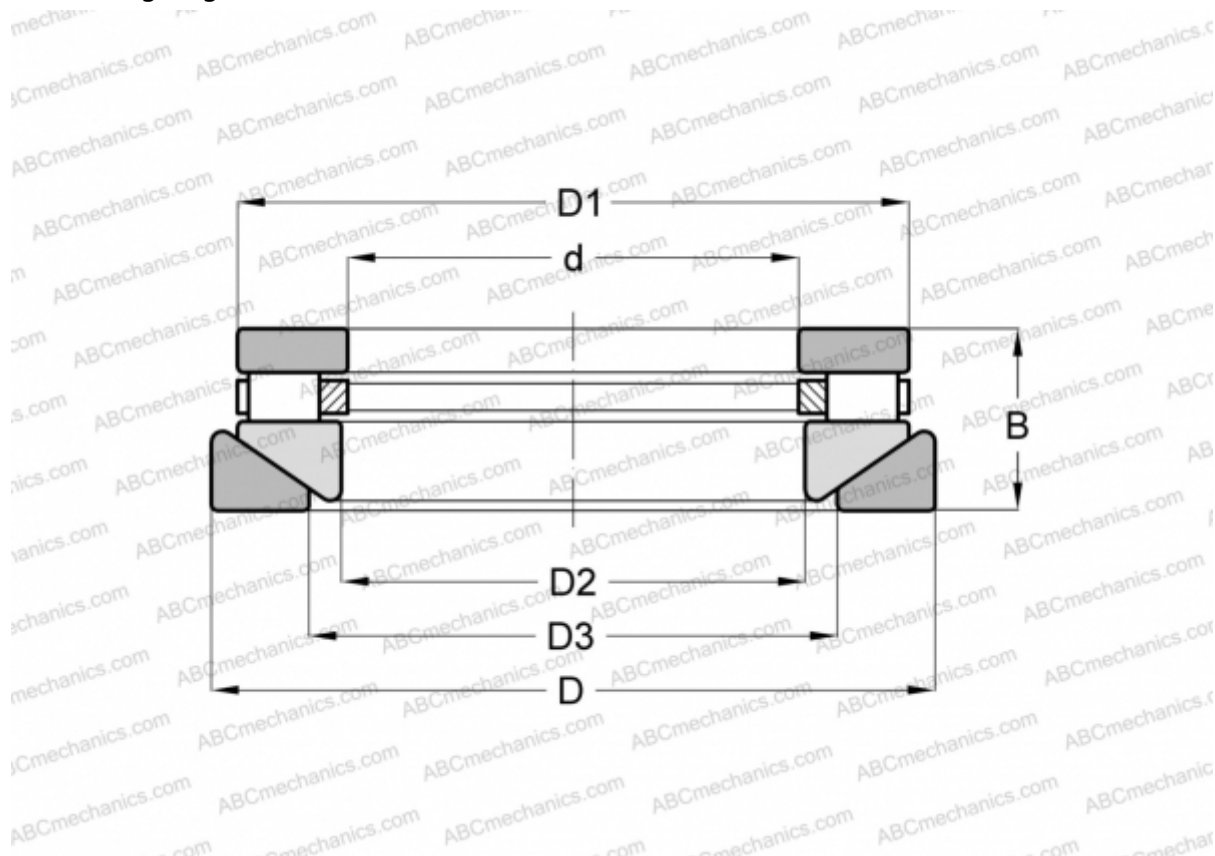

## AT-616 ROLLWAY

Cylindrical roller thrust bearings

TYPE: Roller bearings, Thrust roller bearing, Cylindrical, Single direction, separable, cylindrical rollers, inch sizes, self-aligning



### Technical specification

#### DIMENSIONS, MM

d	49,213
D	92,075
D1	86,518
D2	50,800
D3	57,150
B	33,338

**WEIGHT, KG** 0,998

**MANUFACTURER** [ROLLWAY](#)

#### INTERCHANGE

ANDREWS	<a href="#">RTWM-616</a>
INA	<a href="#">RTW-616</a>

