

## RTWM-617 ANDREWS

Cylindrical roller thrust bearings

TYPE: Roller bearings, Thrust roller bearing, Cylindrical, Single direction, separable, cylindrical rollers, inch sizes, self-aligning

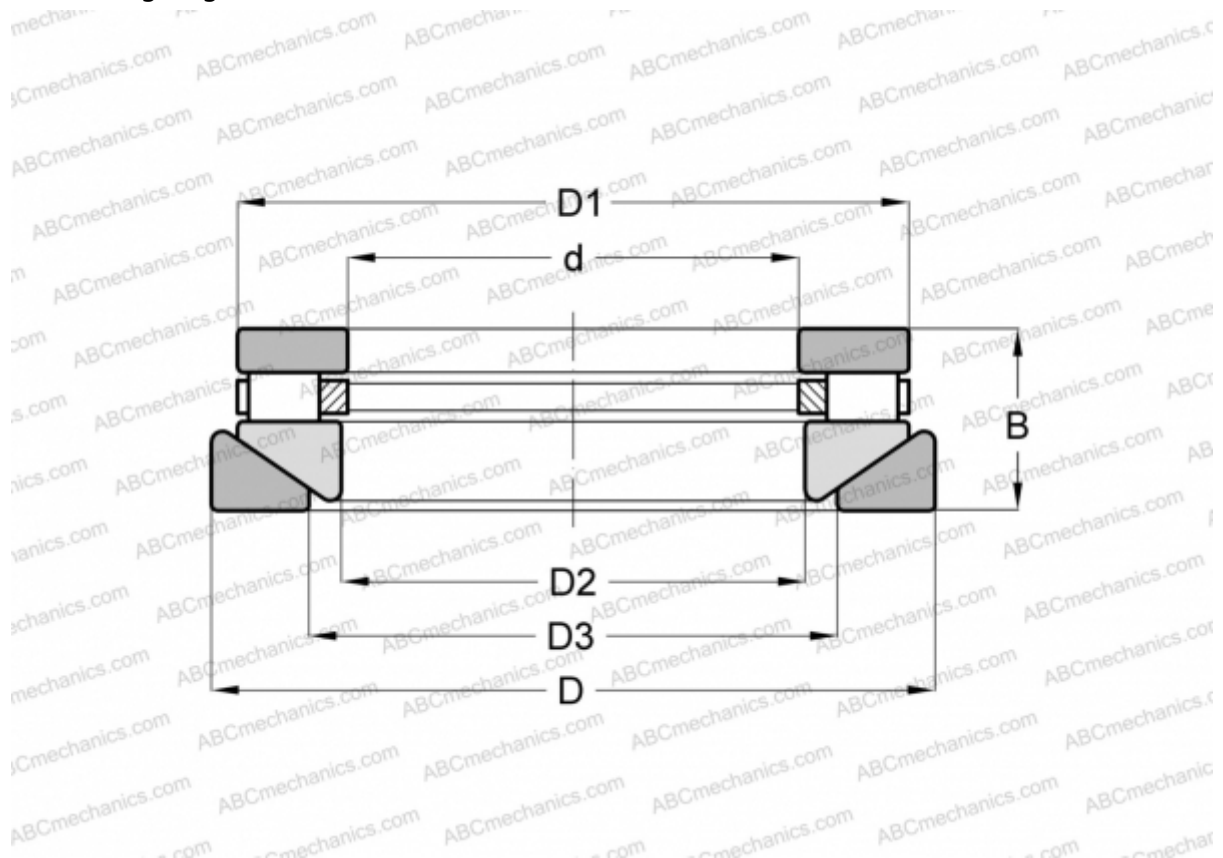

### Technical specification

#### DIMENSIONS, MM

d	50,800
D	95,250
D1	89,296
D2	52,388
D3	61,913
B	33,338

**WEIGHT, KG** 1,043

**MANUFACTURER** [ANDREWS](#)

#### INTERCHANGE

ROLLWAY	<a href="#">AT-617</a>
INA	<a href="#">RTW-617</a>