

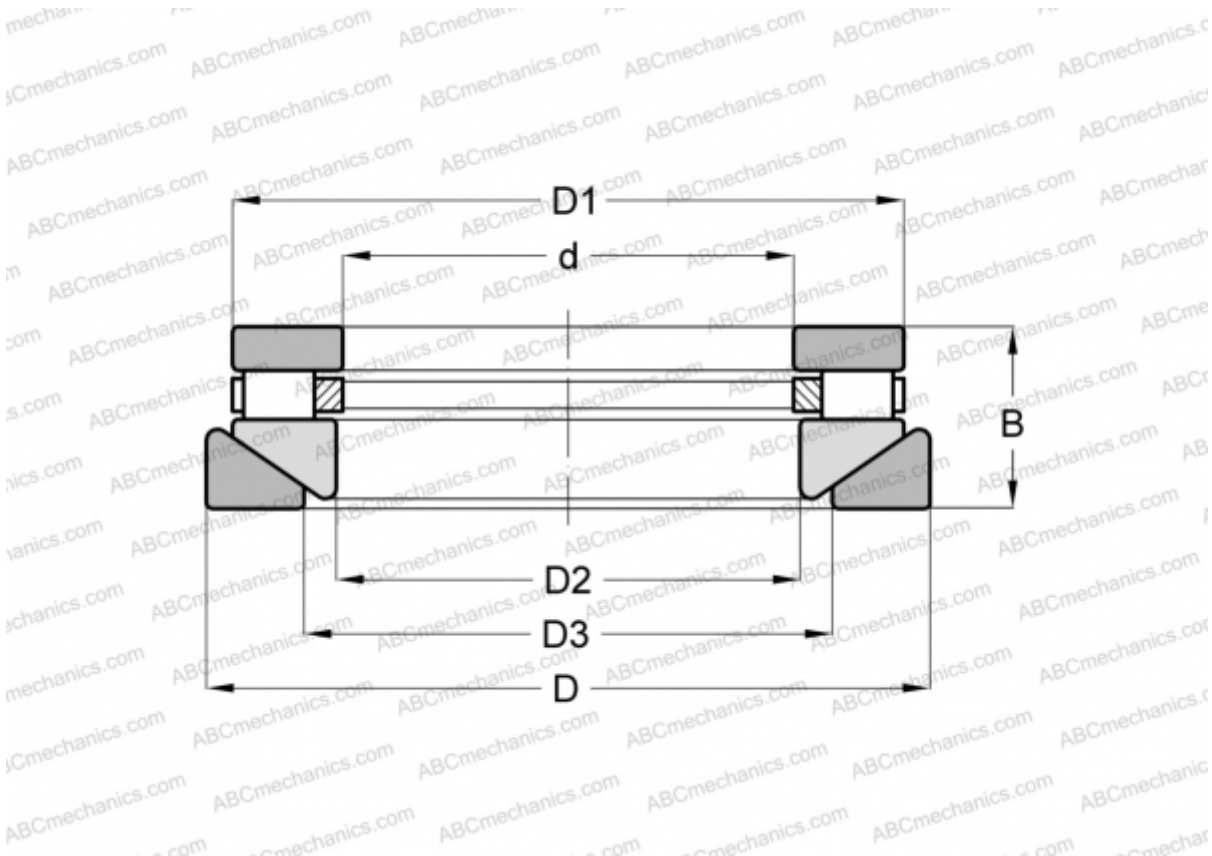

AT-618 ROLLWAY

Cylindrical roller thrust bearings

TYPE: Roller bearings, Thrust roller bearing, Cylindrical, Single direction, separable, cylindrical rollers, inch sizes, self-aligning



Technical specification

DIMENSIONS, MM	
d	53,975
D	98,425
D1	92,868
D2	55,563
D3	63,500
B	33,338
WEIGHT, KG	
	1,043
MANUFACTURER	
	ROLLWAY
INTERCHANGE	
ANDREWS	RTWM-618
INA	RTW-618

