

RTWM-619 ANDREWS

Cylindrical roller thrust bearings

TYPE: Roller bearings, Thrust roller bearing, Cylindrical, Single direction, separable, cylindrical rollers, inch sizes, self-aligning

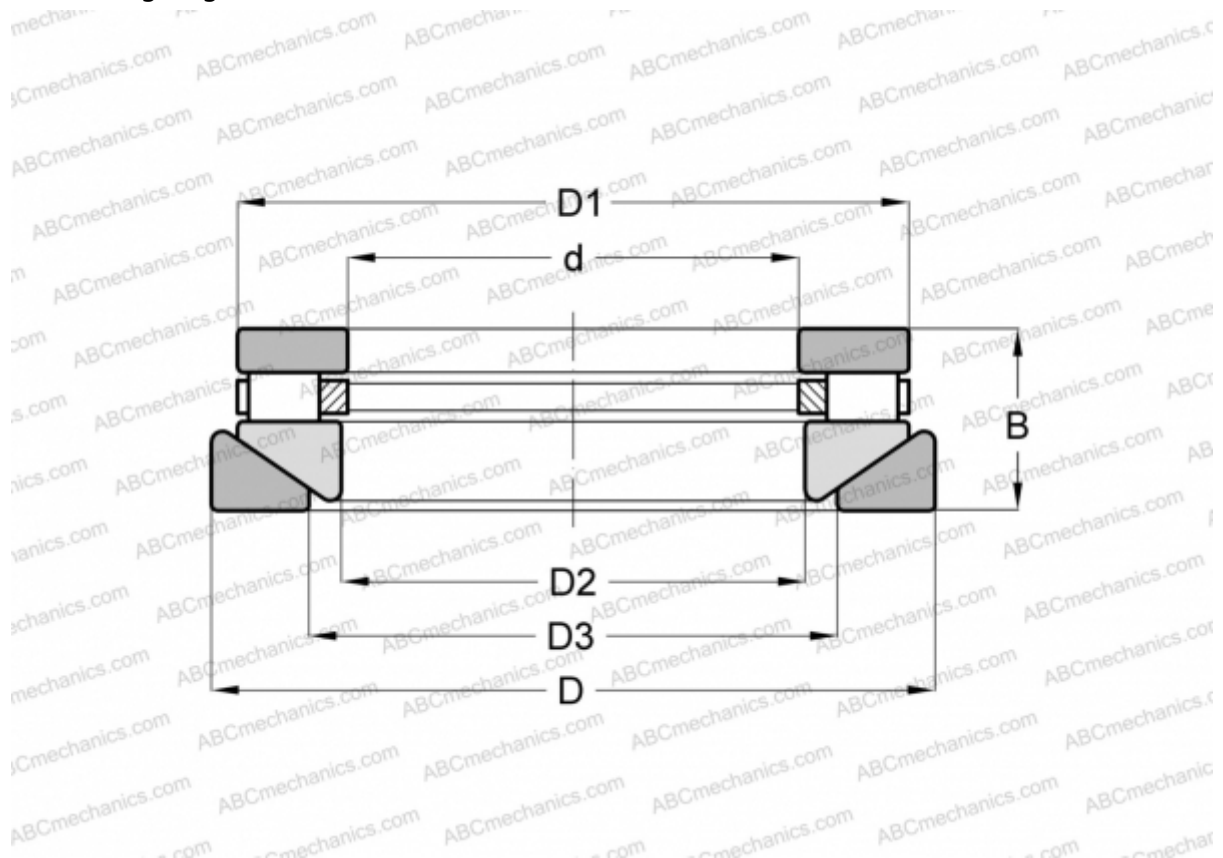

Technical specification

DIMENSIONS, MM

d	57,150
D	101,600
D1	95,250
D2	58,738
D3	68,263
B	33,338

WEIGHT, KG 1,134

MANUFACTURER [ANDREWS](#)

INTERCHANGE

ROLLWAY	AT-619
INA	RTW-619