

## RTW-619 INA

Cylindrical roller thrust bearings

TYPE: Roller bearings, Thrust roller bearing, Cylindrical, Single direction, separable, cylindrical rollers, inch sizes, self-aligning

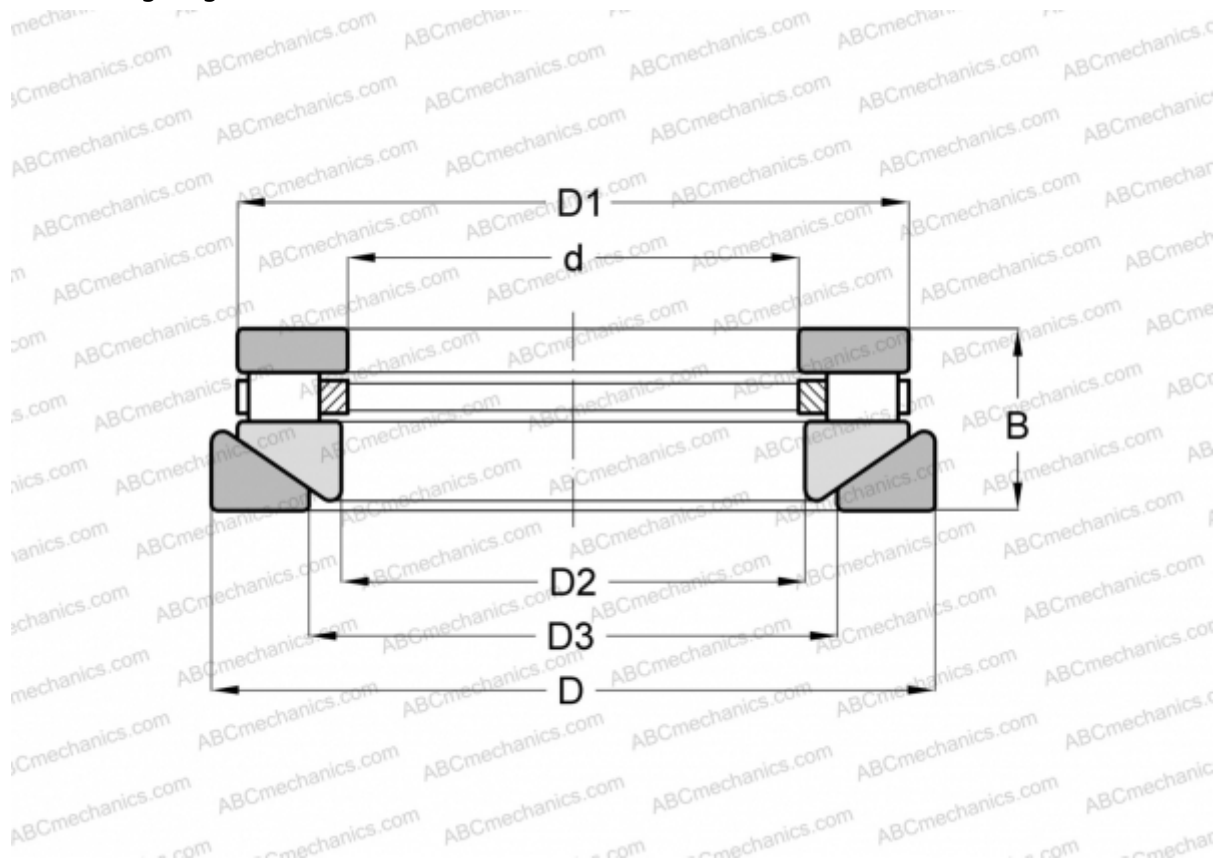

### Technical specification

#### DIMENSIONS, MM

d	57,150
D	101,600
D1	95,250
D2	58,738
D3	68,263
B	33,338

**WEIGHT, KG** 1,134

**MANUFACTURER** [INA](#)

#### INTERCHANGE

ROLLWAY	<a href="#">AT-619</a>
ANDREWS	<a href="#">RTWM-619</a>