

## AT-621 ROLLWAY

Cylindrical roller thrust bearings

TYPE: Roller bearings, Thrust roller bearing, Cylindrical, Single direction, separable, cylindrical rollers, inch sizes, self-aligning

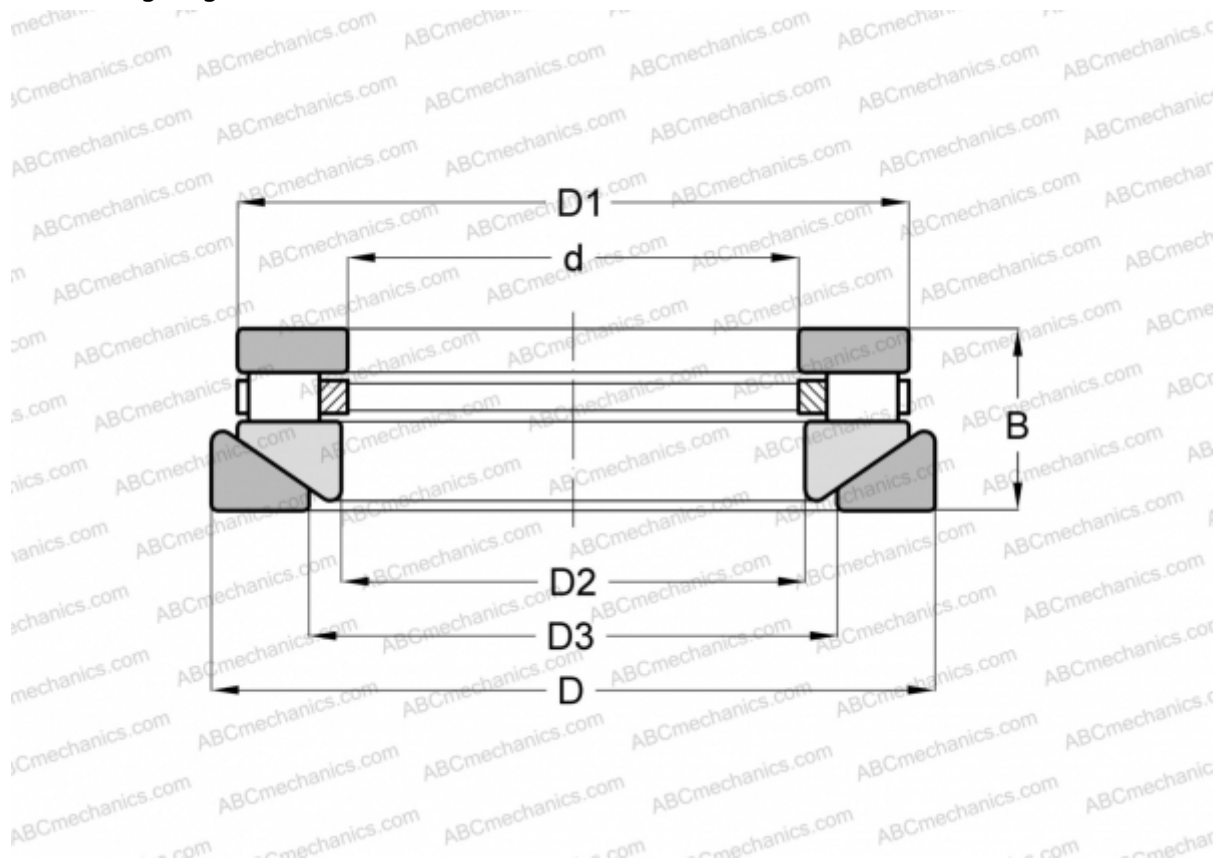

### Technical specification

#### DIMENSIONS, MM

d	63,500
D	107,950
D1	101,600
D2	65,088
D3	73,025
B	33,338

**WEIGHT, KG** 1,225

**MANUFACTURER** [ROLLWAY](#)

#### INTERCHANGE

ANDREWS	<a href="#">RTWM-621</a>
INA	<a href="#">RTW-621</a>