

RTWM-623 ANDREWS

Cylindrical roller thrust bearings

TYPE: Roller bearings, Thrust roller bearing, Cylindrical, Single direction, separable, cylindrical rollers, inch sizes, self-aligning

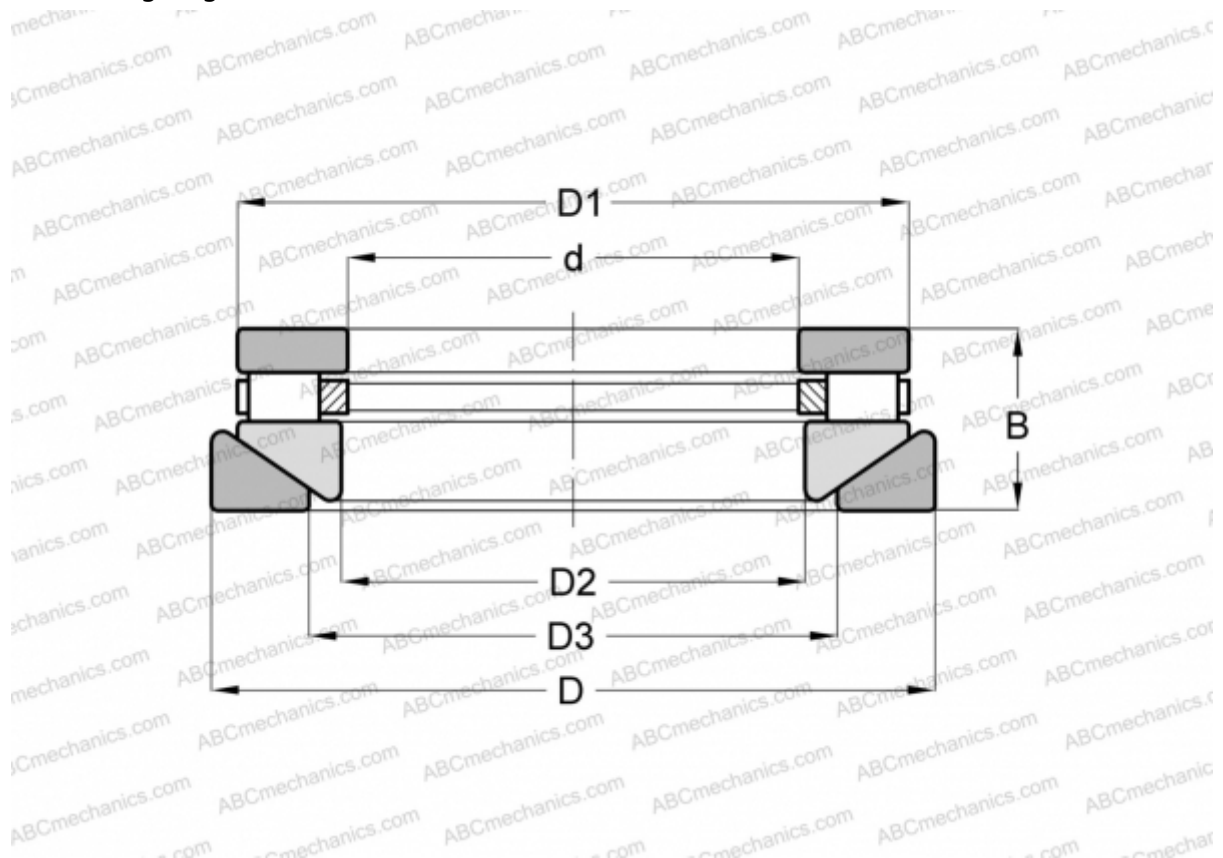

Technical specification

DIMENSIONS, MM

d	69,850
D	118,237
D1	110,330
D2	71,438
D3	84,138
B	33,338

WEIGHT, KG 1,451

MANUFACTURER [ANDREWS](#)

INTERCHANGE

ROLLWAY	AT-623
INA	RTW-623