

AT-624 ROLLWAY

Cylindrical roller thrust bearings

TYPE: Roller bearings, Thrust roller bearing, Cylindrical, Single direction, separable, cylindrical rollers, inch sizes, self-aligning

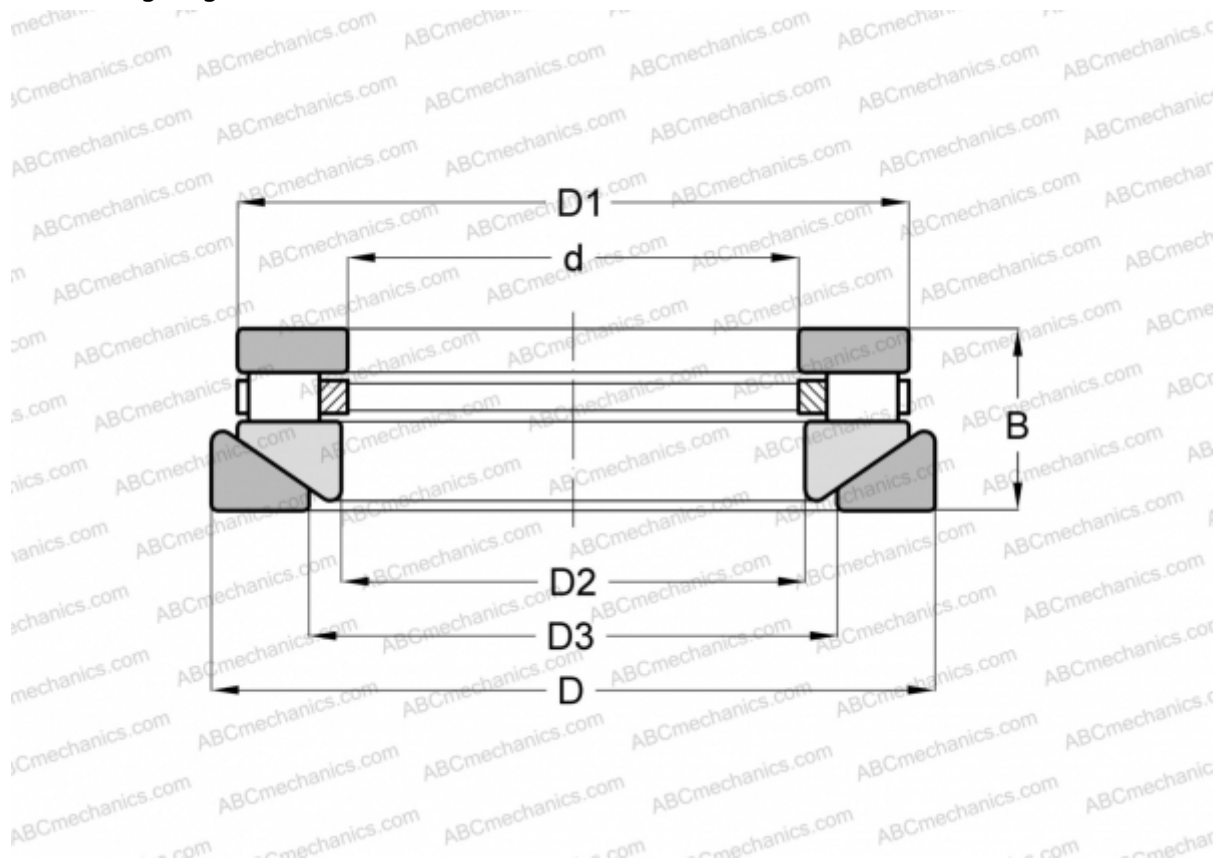

Technical specification

DIMENSIONS, MM

d	76,200
D	126,205
D1	116,680
D2	77,788
D3	88,900
B	33,338

WEIGHT, KG 1,542

MANUFACTURER [ROLLWAY](#)

INTERCHANGE

ANDREWS	RTWM-624
INA	RTW-624