

## RTWH-727 ANDREWS

Cylindrical roller thrust bearings

TYPE: Roller bearings, Thrust roller bearing, Cylindrical, Single direction, separable, cylindrical rollers, inch sizes, self-aligning

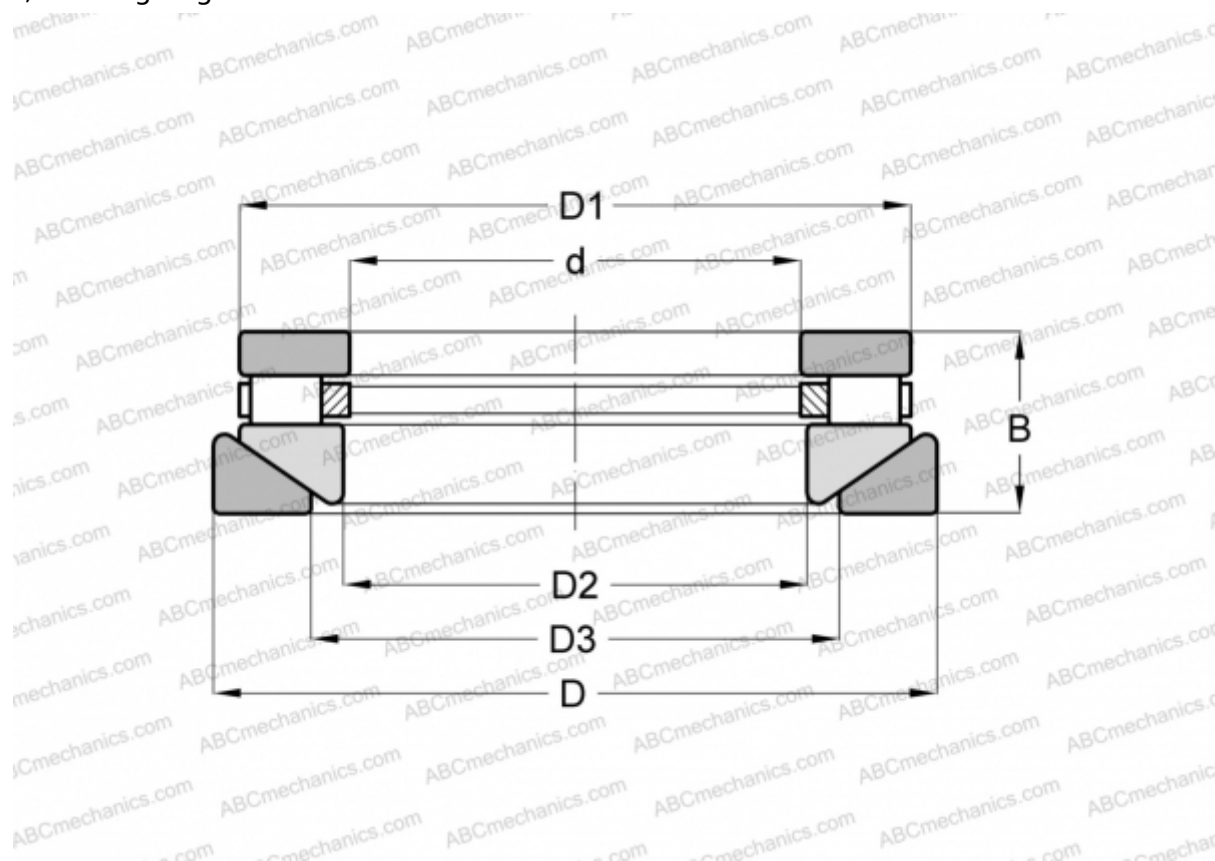

### Technical specification

#### DIMENSIONS, MM

|    |         |
|----|---------|
| d  | 50,800  |
| D  | 160,337 |
| D1 | 150,812 |
| D2 | 52,388  |
| D3 | 85,725  |
| B  | 46,038  |

**WEIGHT, KG** 5,216

**MANUFACTURER** [ANDREWS](#)

#### INTERCHANGE

|            |                            |
|------------|----------------------------|
| ROLLWAY    | <a href="#">AT-727</a>     |
| INA        | <a href="#">RTW-727</a>    |
| TORRINGTON | <a href="#">20 TPS 103</a> |