

## RTW-727 INA

Cylindrical roller thrust bearings

TYPE: Roller bearings, Thrust roller bearing, Cylindrical, Single direction, separable, cylindrical rollers, inch sizes, self-aligning

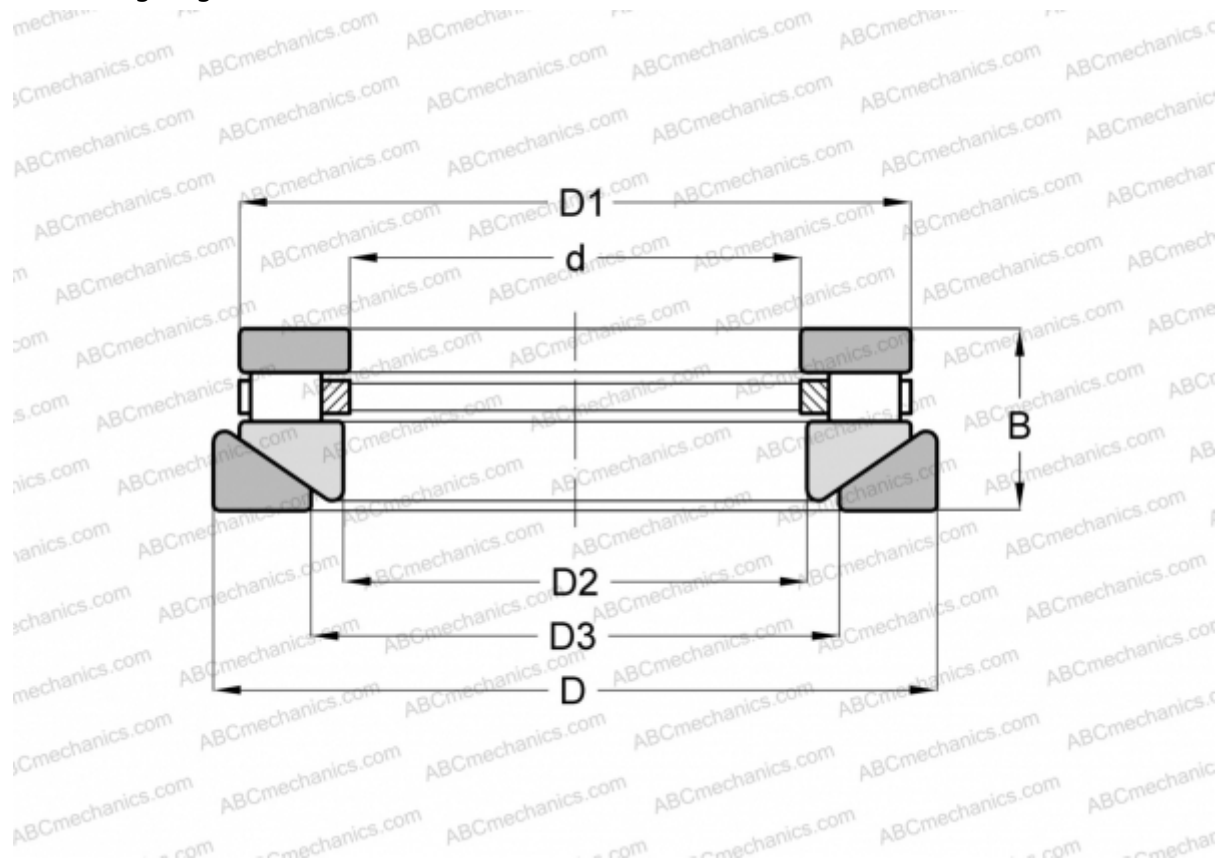

### Technical specification

#### DIMENSIONS, MM

d	50,800
D	160,337
D1	150,812
D2	52,388
D3	85,725
B	46,038

**WEIGHT, KG** 5,216

**MANUFACTURER** [INA](#)

#### INTERCHANGE

ROLLWAY	<a href="#">AT-727</a>
ANDREWS	<a href="#">RTWH-727</a>
TORRINGTON	<a href="#">20 TPS 103</a>