

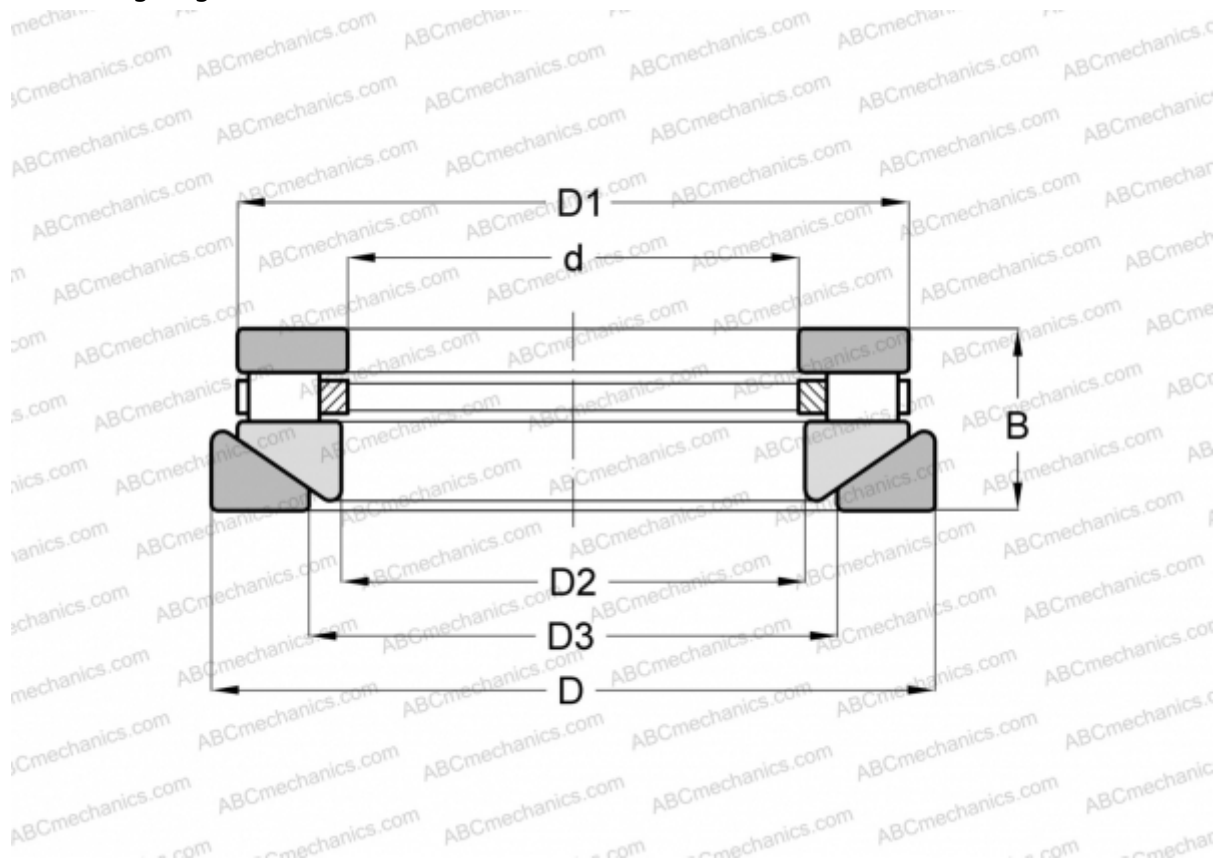

20 TPS 103 TORRINGTON

Cylindrical roller thrust bearings

TYPE: Roller bearings, Thrust roller bearing, Cylindrical, Single direction, separable, cylindrical rollers, inch sizes, self-aligning



Technical specification

DIMENSIONS, MM

d	50,800
D	160,337
D1	150,812
D2	52,388
D3	85,725
B	46,038

WEIGHT, KG 5,216

MANUFACTURER [TORRINGTON](#)

INTERCHANGE

ROLLWAY	AT-727
ANDREWS	RTWH-727
INA	RTW-727

