

## AT-732 ROLLWAY

Cylindrical roller thrust bearings

TYPE: Roller bearings, Thrust roller bearing, Cylindrical, Single direction, separable, cylindrical rollers, inch sizes, self-aligning

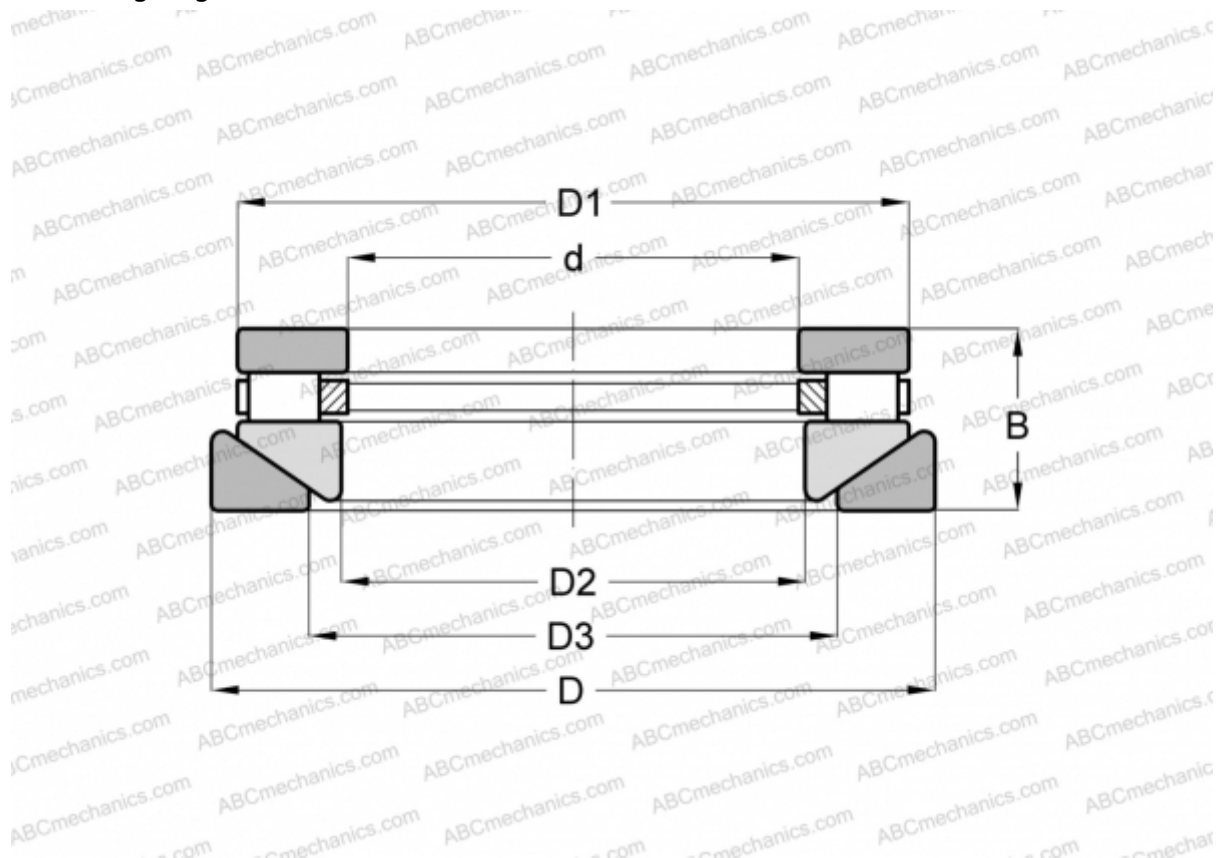

### Technical specification

#### DIMENSIONS, MM

d	76,200
D	211,137
D1	201,613
D2	77,788
D3	133,350
B	46,038

**WEIGHT, KG** 9,072

**MANUFACTURER** [ROLLWAY](#)

#### INTERCHANGE

ANDREWS	<a href="#">RTWH-732</a>
INA	<a href="#">RTW-732</a>
TORRINGTON	<a href="#">30 TPS 108</a>