

30 TPS 108 TORRINGTON

Cylindrical roller thrust bearings

TYPE: Roller bearings, Thrust roller bearing, Cylindrical, Single direction, separable, cylindrical rollers, inch sizes, self-aligning

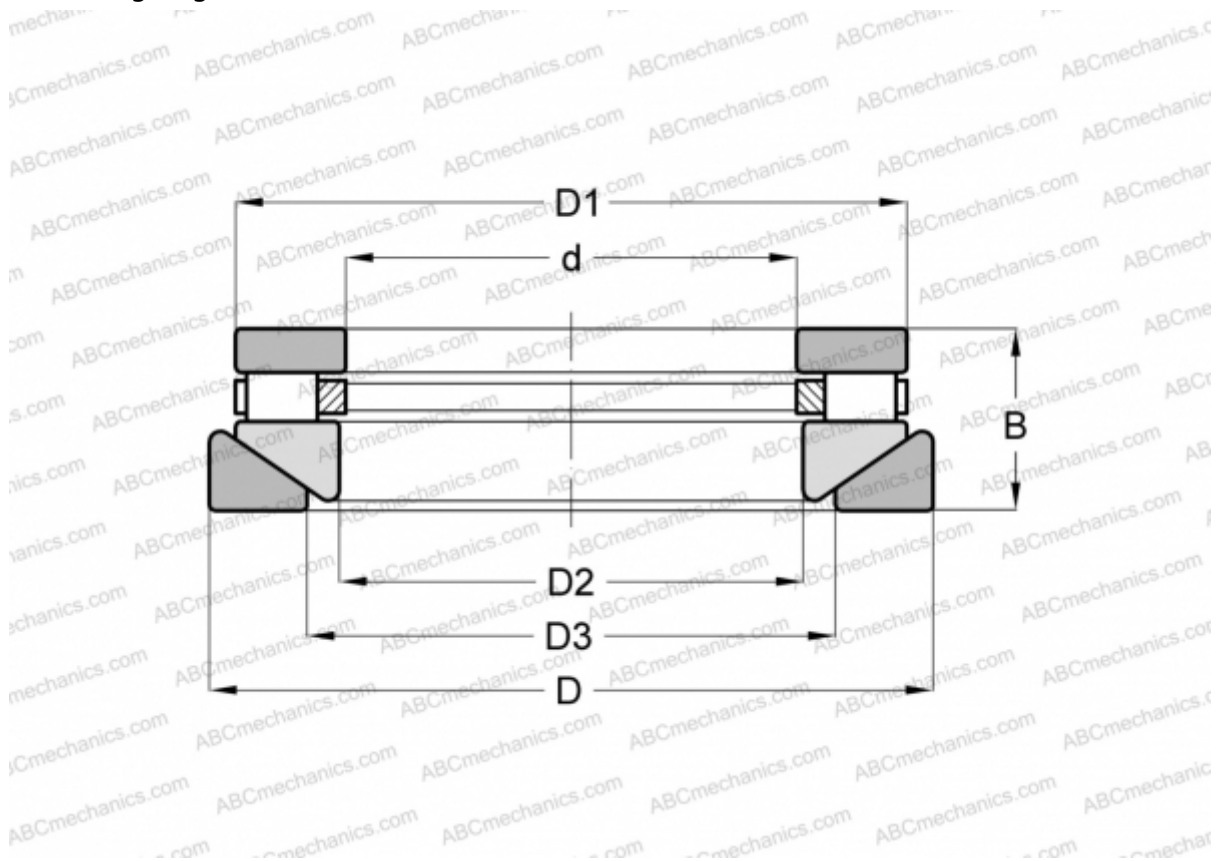

Technical specification

DIMENSIONS, MM

d	76,200
D	211,137
D1	201,613
D2	77,788
D3	133,350
B	46,038

WEIGHT, KG 9,072

MANUFACTURER [TORRINGTON](#)

INTERCHANGE

ROLLWAY	AT-732
ANDREWS	RTWH-732
INA	RTW-732