

AT-734 ROLLWAY

Cylindrical roller thrust bearings

TYPE: Roller bearings, Thrust roller bearing, Cylindrical, Single direction, separable, cylindrical rollers, inch sizes, self-aligning

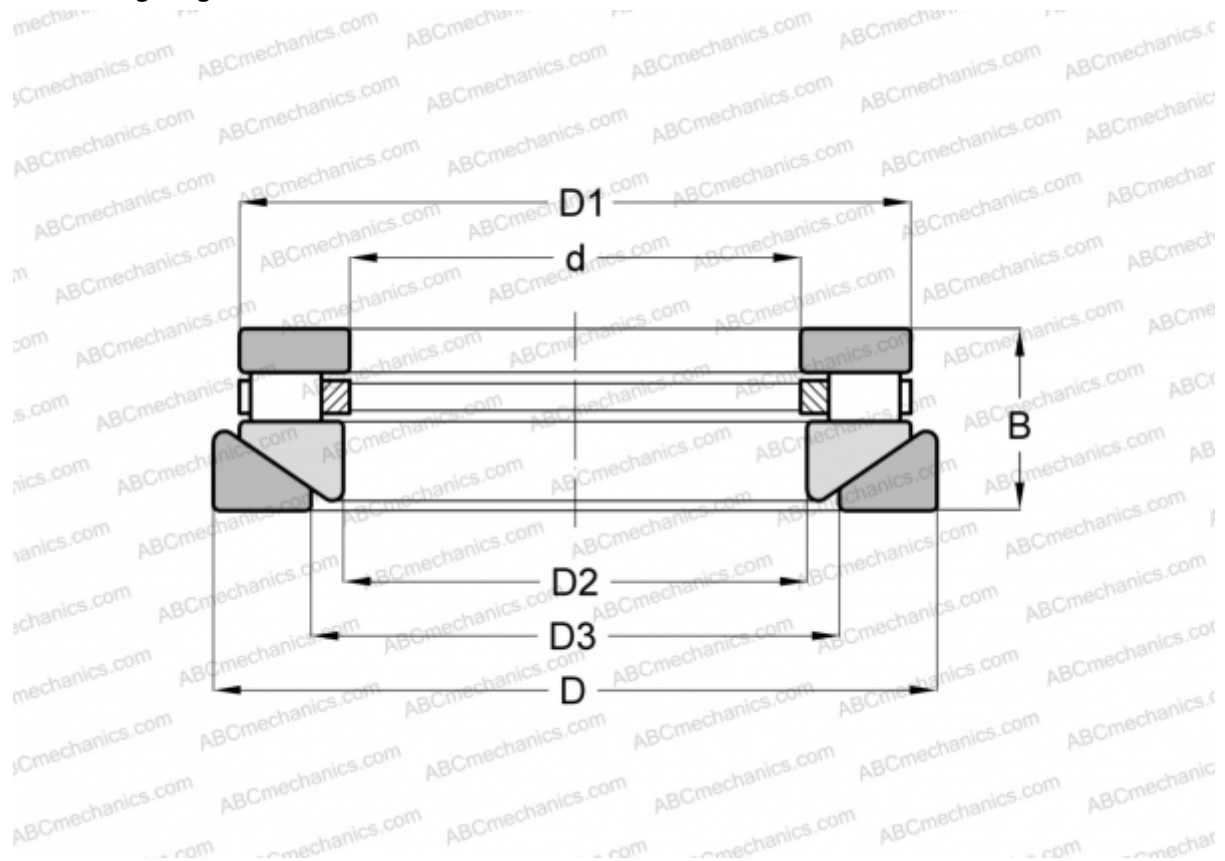

Technical specification

DIMENSIONS, MM

d	101,600
D	187,325
D1	176,212
D2	103,980
D3	127,000
B	58,738

WEIGHT, KG 6,804

MANUFACTURER [ROLLWAY](#)

INTERCHANGE

ANDREWS	RTWH-734
INA	RTW-734
TORRINGTON	40 TPS 114