

40 TPS 114 TORRINGTON

Cylindrical roller thrust bearings

TYPE: Roller bearings, Thrust roller bearing, Cylindrical, Single direction, separable, cylindrical rollers, inch sizes, self-aligning

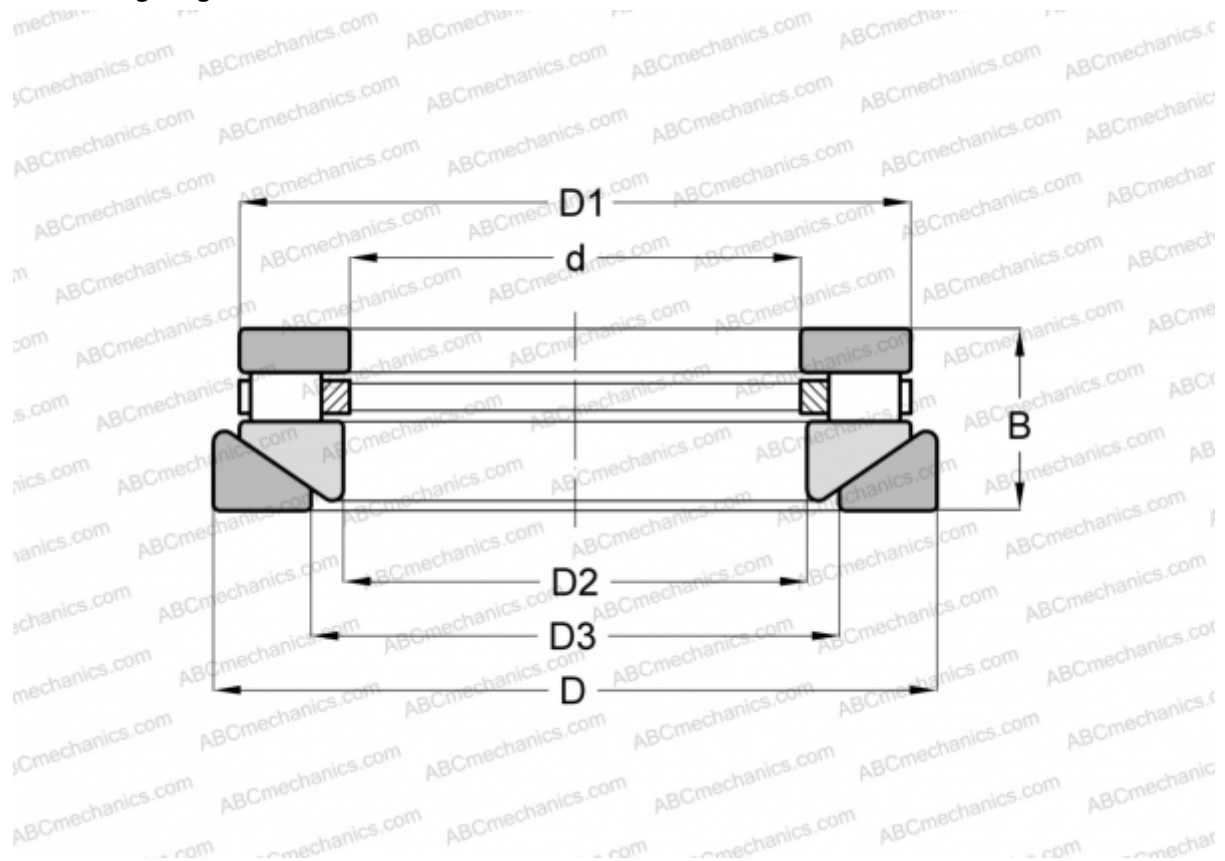

Technical specification

DIMENSIONS, MM

d	101,600
D	187,325
D1	176,212
D2	103,980
D3	127,000
B	58,738

WEIGHT, KG 6,804

MANUFACTURER [TORRINGTON](#)

INTERCHANGE

ROLLWAY	AT-734
ANDREWS	RTWH-734
INA	RTW-734