

RTWH-735 ANDREWS

Cylindrical roller thrust bearings

TYPE: Roller bearings, Thrust roller bearing, Cylindrical, Single direction, separable, cylindrical rollers, inch sizes, self-aligning

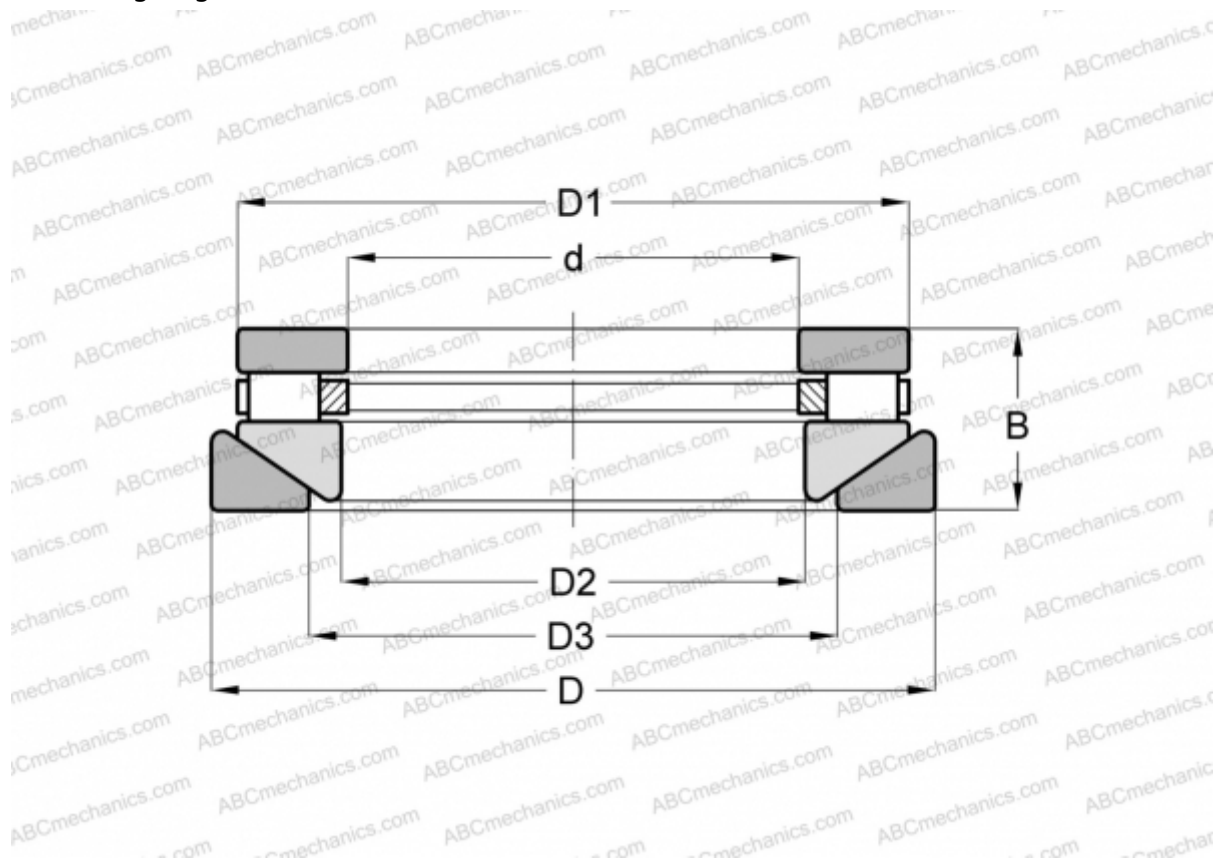

Technical specification

DIMENSIONS, MM

d	101,600
D	212,725
D1	201,613
D2	103,980
D3	133,350
B	58,738

WEIGHT, KG 9,979

MANUFACTURER [ANDREWS](#)

INTERCHANGE

ROLLWAY	AT-735
INA	RTW-735
TORRINGTON	40 TPS 115