

AT-736 ROLLWAY

Cylindrical roller thrust bearings

TYPE: Roller bearings, Thrust roller bearing, Cylindrical, Single direction, separable, cylindrical rollers, inch sizes, self-aligning

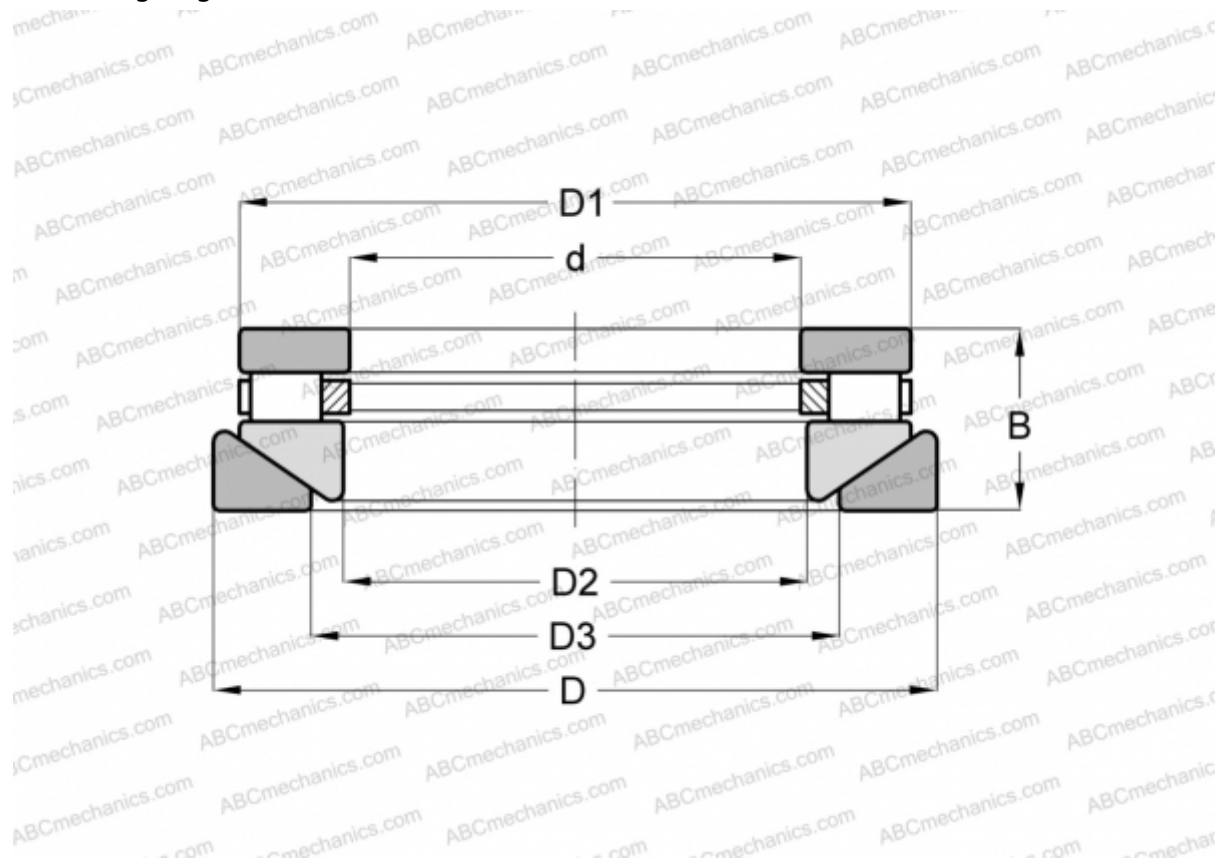

Technical specification

DIMENSIONS, MM

d	101,600
D	238,125
D1	227,012
D2	103,980
D3	149,225
B	58,738

WEIGHT, KG 13,608

MANUFACTURER [ROLLWAY](#)

INTERCHANGE

ANDREWS	RTWH-736
INA	RTW-736
TORRINGTON	40 TPS 116