

AT-737 ROLLWAY

Cylindrical roller thrust bearings

TYPE: Roller bearings, Thrust roller bearing, Cylindrical, Single direction, separable, cylindrical rollers, inch sizes, self-aligning

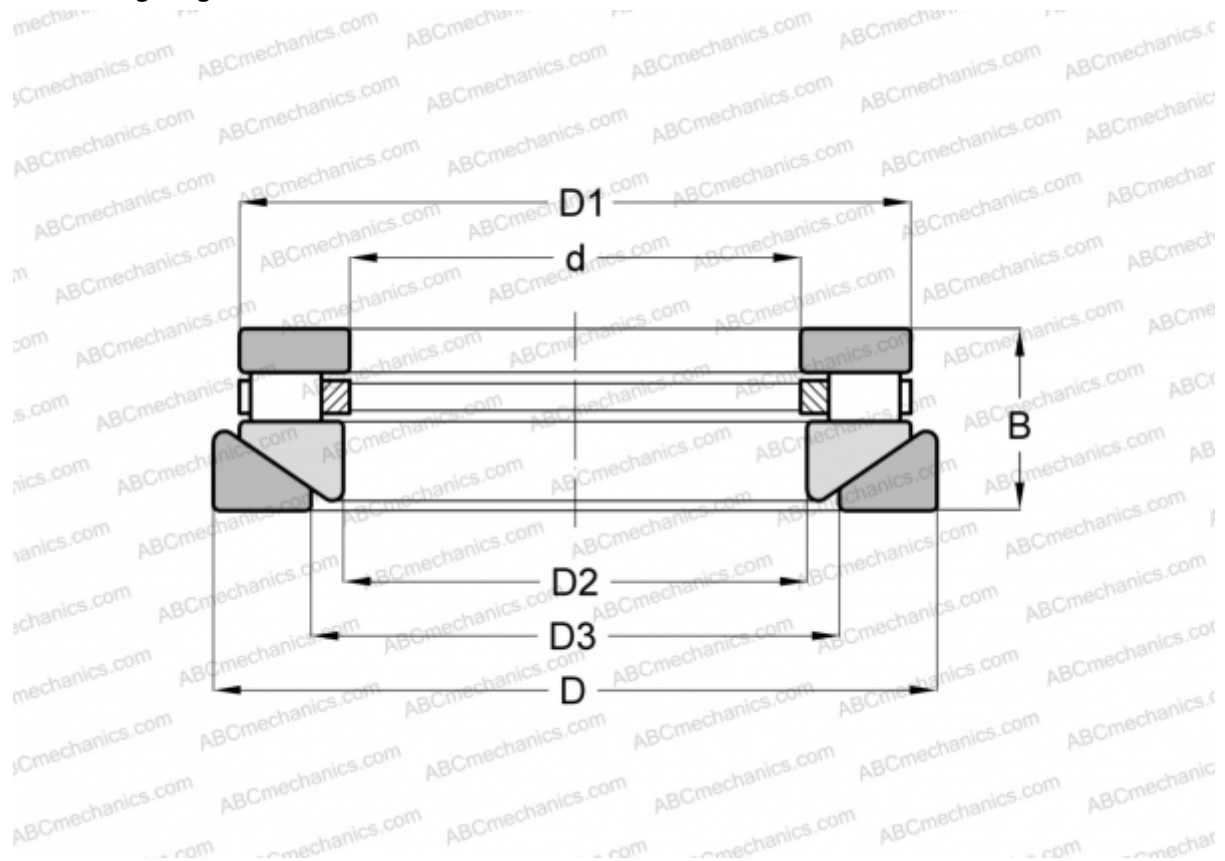

Technical specification

DIMENSIONS, MM

d	101,600
D	266,700
D1	252,413
D2	103,980
D3	165,100
B	58,738

WEIGHT, KG 17,690

MANUFACTURER [ROLLWAY](#)

INTERCHANGE

ANDREWS	RTWH-737
INA	RTW-737
TORRINGTON	40 TPS 117