

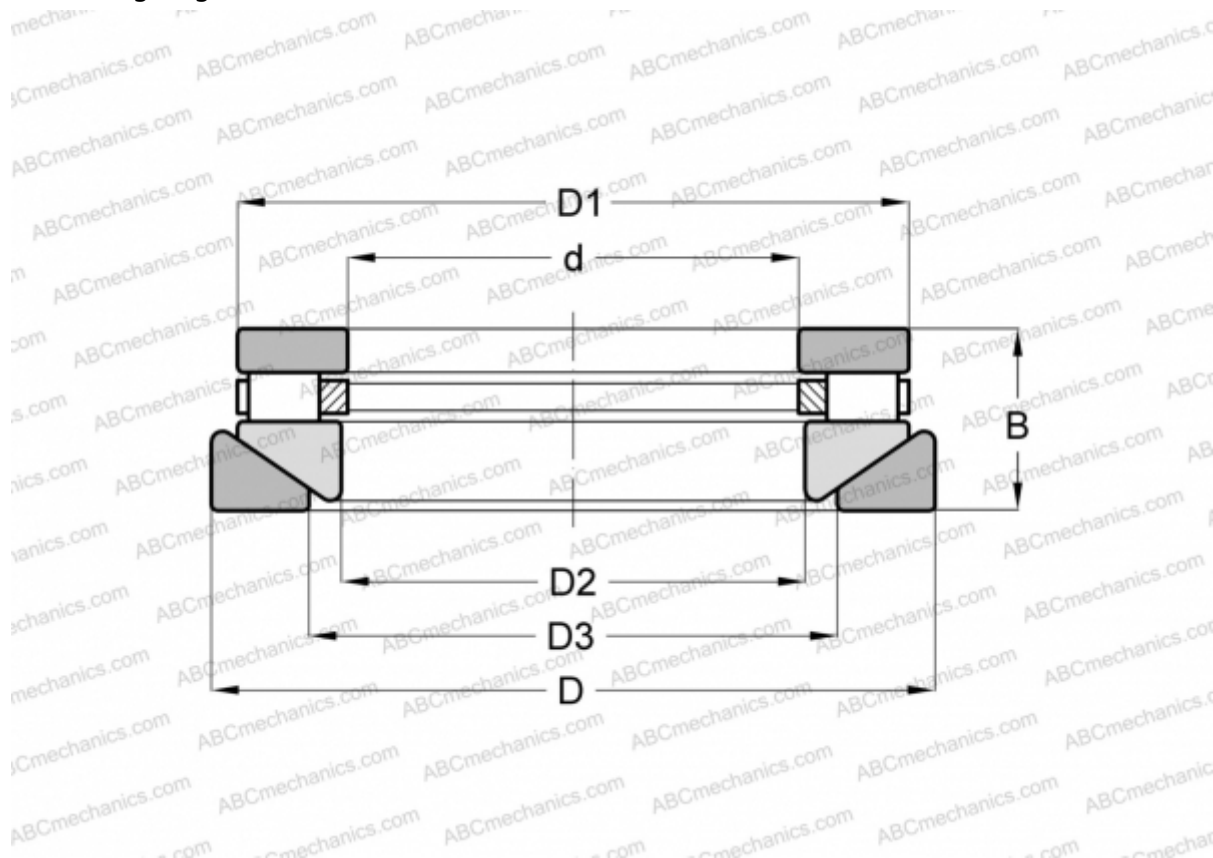

## 50 TPS 120 TORRINGTON

Cylindrical roller thrust bearings

TYPE: Roller bearings, Thrust roller bearing, Cylindrical, Single direction, separable, cylindrical rollers, inch sizes, self-aligning



### Technical specification

#### DIMENSIONS, MM

d	127,000
D	241,300
D1	227,012
D2	130,175
D3	155,575
B	58,738

**WEIGHT, KG** 11,793

**MANUFACTURER** [TORRINGTON](#)

#### INTERCHANGE

ROLLWAY	<a href="#">AT-739</a>
ANDREWS	<a href="#">RTWH-739</a>
INA	<a href="#">RTW-739</a>

