

## 50 TPS 122 TORRINGTON

Cylindrical roller thrust bearings

TYPE: Roller bearings, Thrust roller bearing, Cylindrical, Single direction, separable, cylindrical rollers, inch sizes, self-aligning

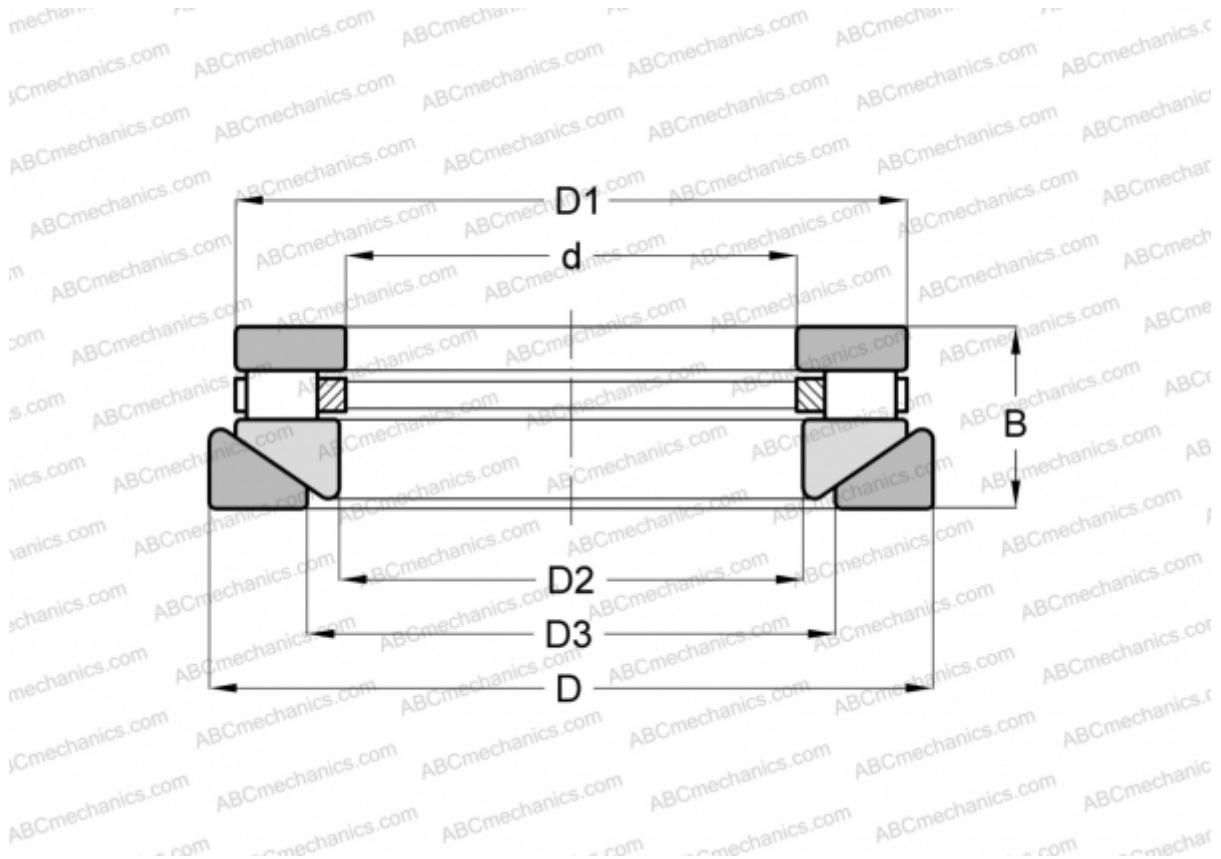

### Technical specification

#### DIMENSIONS, MM

d	127,000
D	292,100
D1	277,812
D2	130,175
D3	177,800
B	66,675

**WEIGHT, KG** 22,680

**MANUFACTURER** [TORRINGTON](#)

#### INTERCHANGE

ROLLWAY	<a href="#">AT-741</a>
ANDREWS	<a href="#">RTWH-741</a>
INA	<a href="#">RTW-741</a>