

## RTWH-742 ANDREWS

Cylindrical roller thrust bearings

TYPE: Roller bearings, Thrust roller bearing, Cylindrical, Single direction, separable, cylindrical rollers, inch sizes, self-aligning

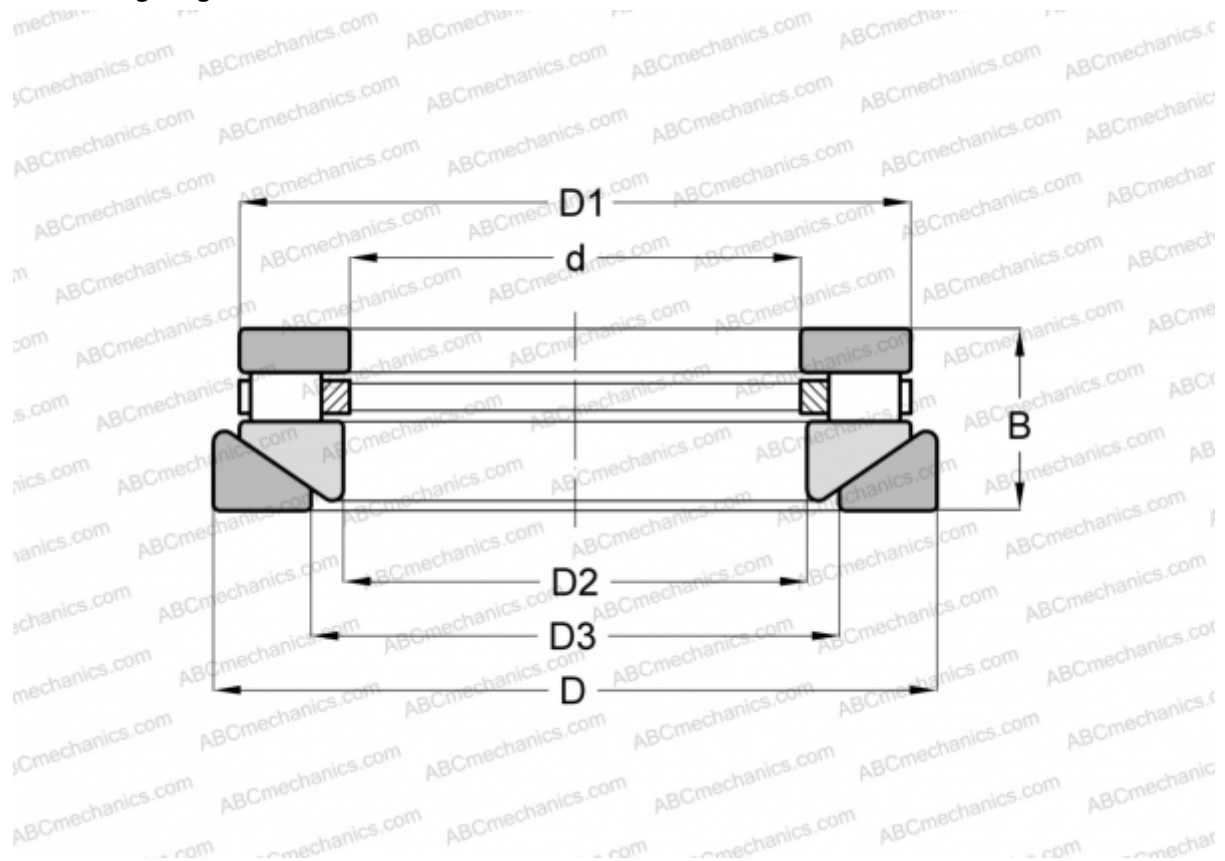

### Technical specification

#### DIMENSIONS, MM

d	127,000
D	317,500
D1	303,212
D2	130,175
D3	184,150
B	66,675

**WEIGHT, KG** 28,576

**MANUFACTURER** [ANDREWS](#)

#### INTERCHANGE

ROLLWAY	<a href="#">AT-742</a>
INA	<a href="#">RTW-742</a>
TORRINGTON	<a href="#">50 TPS 123</a>