

60 TPS 124 TORRINGTON

Cylindrical roller thrust bearings

TYPE: Roller bearings, Thrust roller bearing, Cylindrical, Single direction, separable, cylindrical rollers, inch sizes, self-aligning

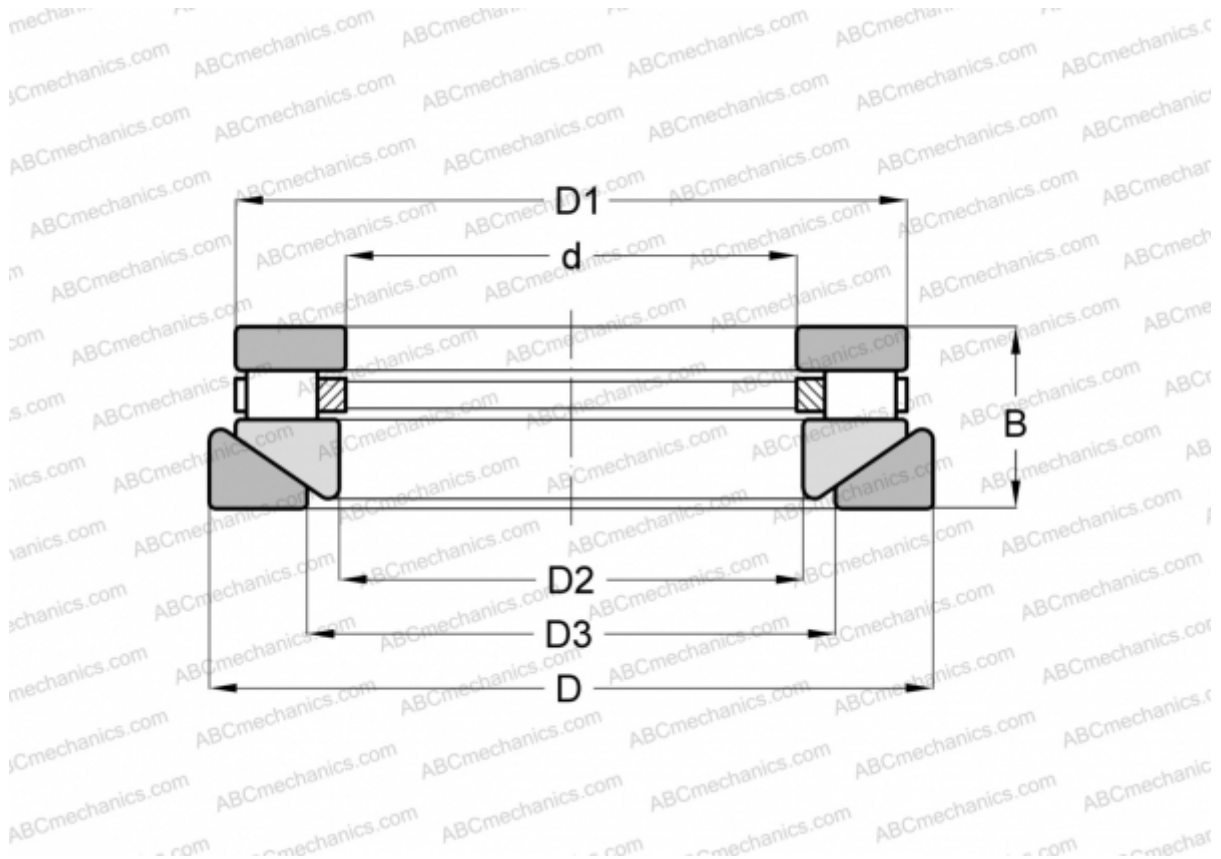

Technical specification

DIMENSIONS, MM

d	152,400
D	241,300
D1	227,012
D2	155,575
D3	184,150
B	66,675

WEIGHT, KG 10,433

MANUFACTURER [TORRINGTON](#)

INTERCHANGE

ROLLWAY	AT-743
ANDREWS	RTWH-743
INA	RTW-743