

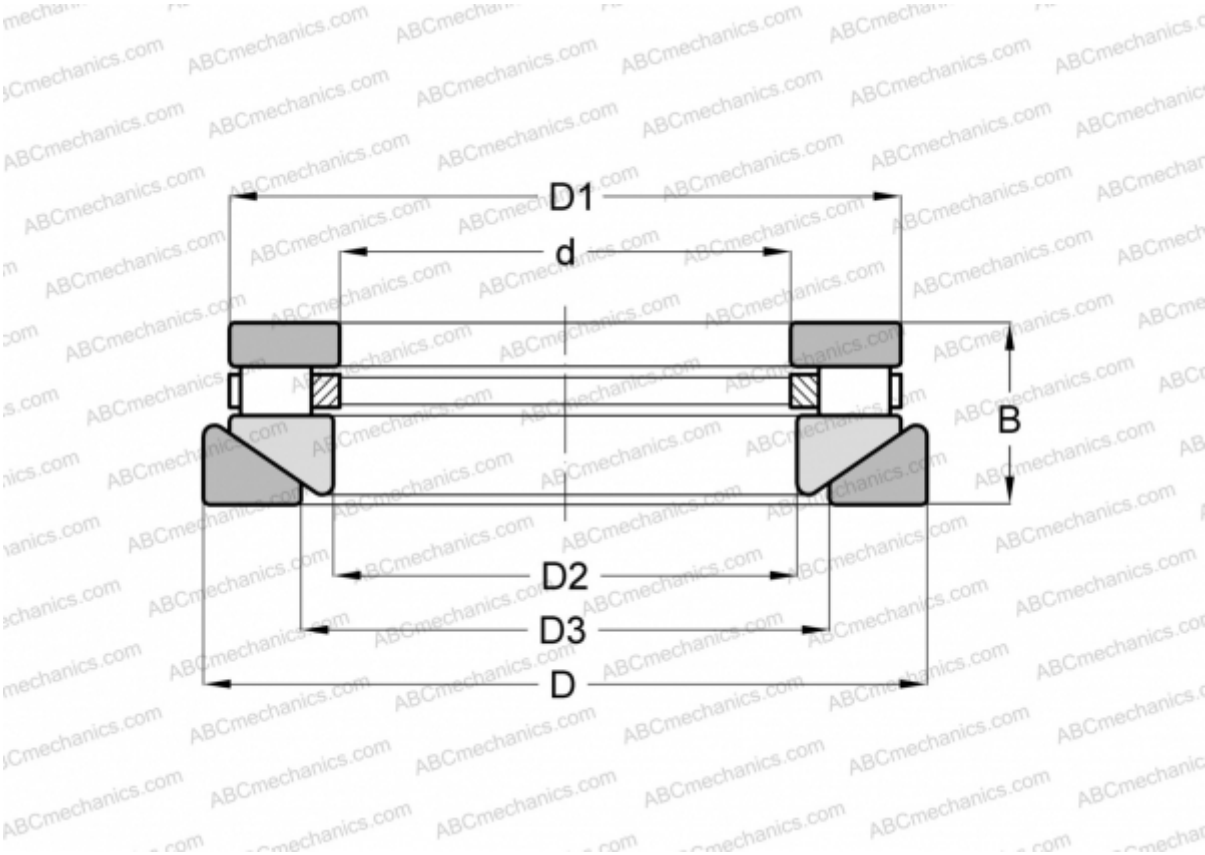

RTWH-745 ANDREWS

Cylindrical roller thrust bearings

TYPE: Roller bearings, Thrust roller bearing, Cylindrical, Single direction, separable, cylindrical rollers, inch sizes, self-aligning



Technical specification

DIMENSIONS, MM

| | |
|----|---------|
| d | 152,400 |
| D | 292,100 |
| D1 | 277,812 |
| D2 | 155,575 |
| D3 | 187,325 |
| B | 66,675 |

WEIGHT, KG19,958

MANUFACTURERANDREWS

INTERCHANGE

| | |
|------------|------------|
| ROLLWAY | AT-745 |
| INA | RTW-745 |
| TORRINGTON | 60 TPS 126 |

