

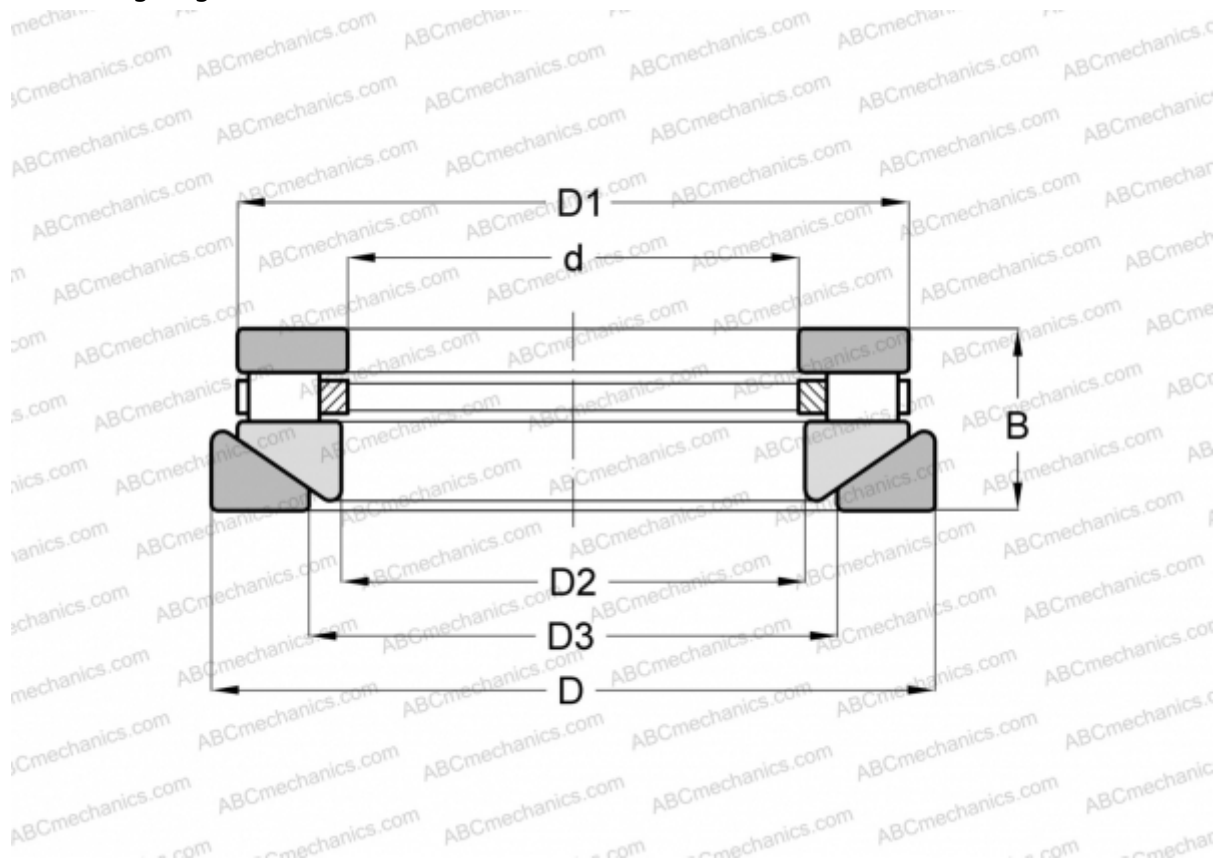

## 60 TPS 126 TORRINGTON

Cylindrical roller thrust bearings

TYPE: Roller bearings, Thrust roller bearing, Cylindrical, Single direction, separable, cylindrical rollers, inch sizes, self-aligning



### Technical specification

#### DIMENSIONS, MM

d	152,400
D	292,100
D1	277,812
D2	155,575
D3	187,325
B	66,675

**WEIGHT, KG** 19,958

**MANUFACTURER** [TORRINGTON](#)

#### INTERCHANGE

ROLLWAY	<a href="#">AT-745</a>
ANDREWS	<a href="#">RTWH-745</a>
INA	<a href="#">RTW-745</a>

