

## RTWH-753 ANDREWS

Cylindrical roller thrust bearings

TYPE: Roller bearings, Thrust roller bearing, Cylindrical, Single direction, separable, cylindrical rollers, inch sizes, self-aligning

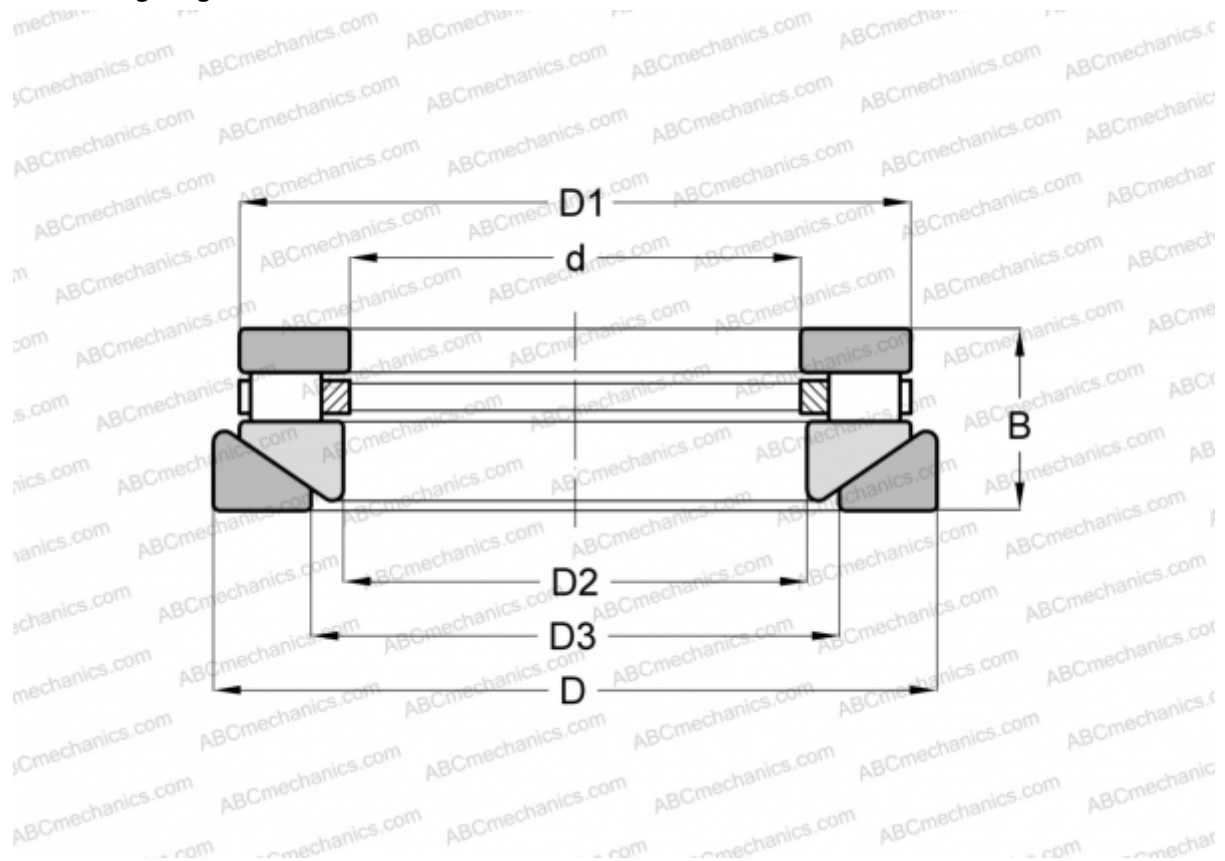

### Technical specification

#### DIMENSIONS, MM

d	203,200
D	428,625
D1	404,038
D2	209,550
D3	266,700
B	101,600

**WEIGHT, KG** 69,853

**MANUFACTURER** [ANDREWS](#)

#### INTERCHANGE

ROLLWAY	<a href="#">AT-753</a>
INA	<a href="#">RTW-753</a>
TORRINGTON	<a href="#">80 TPS 136</a>