

GE 20 FW-2RS FLURO

Spherical plain bearings

TYPE: Plain bearings, Spherical plain bearings and rod ends, Radial spherical plain bearings, Maintenance free, Series GE..-FW-2RS (FLURO), contact seals on both side

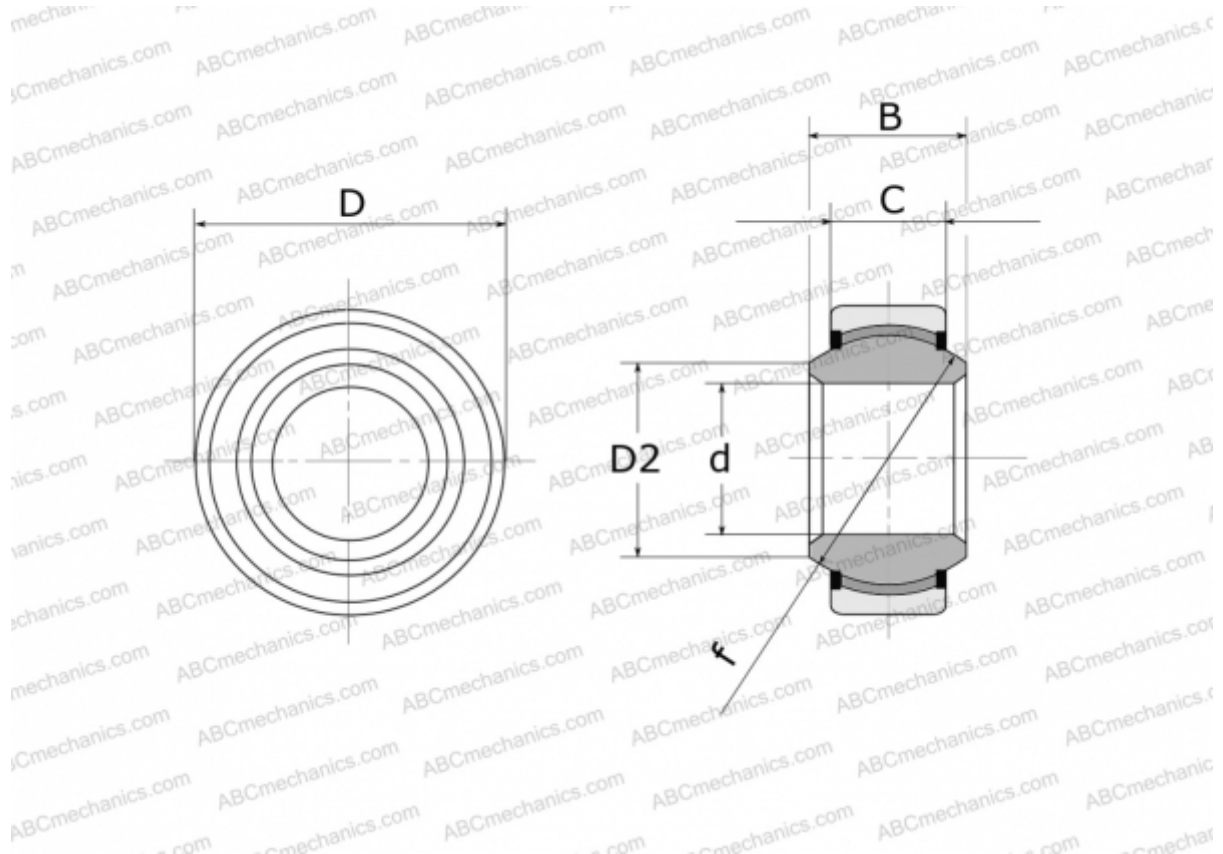

Technical specification

DIMENSIONS, MM

d	20,000
D	42,000
D2	25,200
B	25,000
f	35,500
C	16,000

WEIGHT, KG 0,153

MANUFACTURER [FLURO](#)