

GE 25 FW-2RS FLURO

Spherical plain bearings

TYPE: Plain bearings, Spherical plain bearings and rod ends, Radial spherical plain bearings, Maintenance free, Series GE..-FW-2RS (FLURO), contact seals on both side

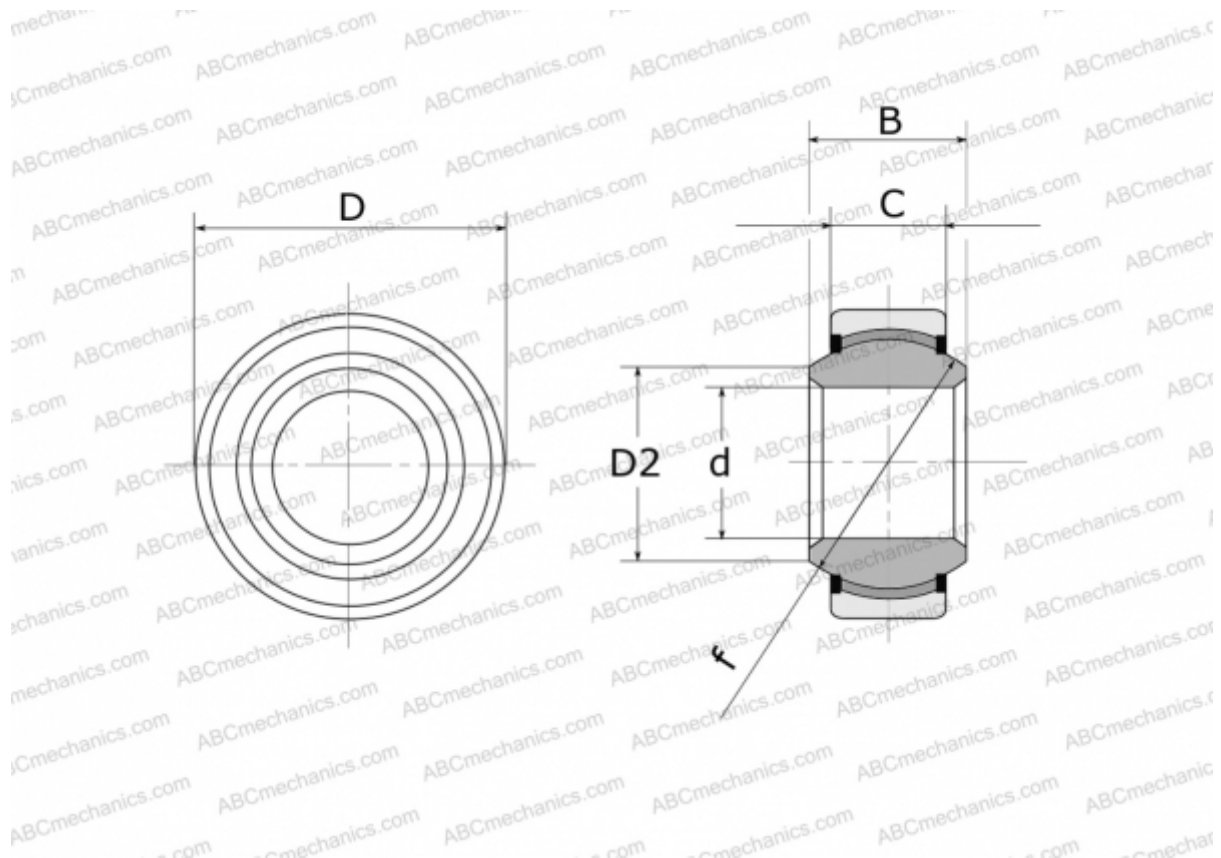

Technical specification

DIMENSIONS, MM

d	25,000
D	47,000
D2	29,500
B	28,000
f	40,700
C	18,000

WEIGHT, KG 0,203

MANUFACTURER [FLURO](#)