

GE 35 FW-2RS FLURO

Spherical plain bearings

TYPE: Plain bearings, Spherical plain bearings and rod ends, Radial spherical plain bearings, Maintenance free, Series GE..-FW-2RS (FLURO), contact seals on both side

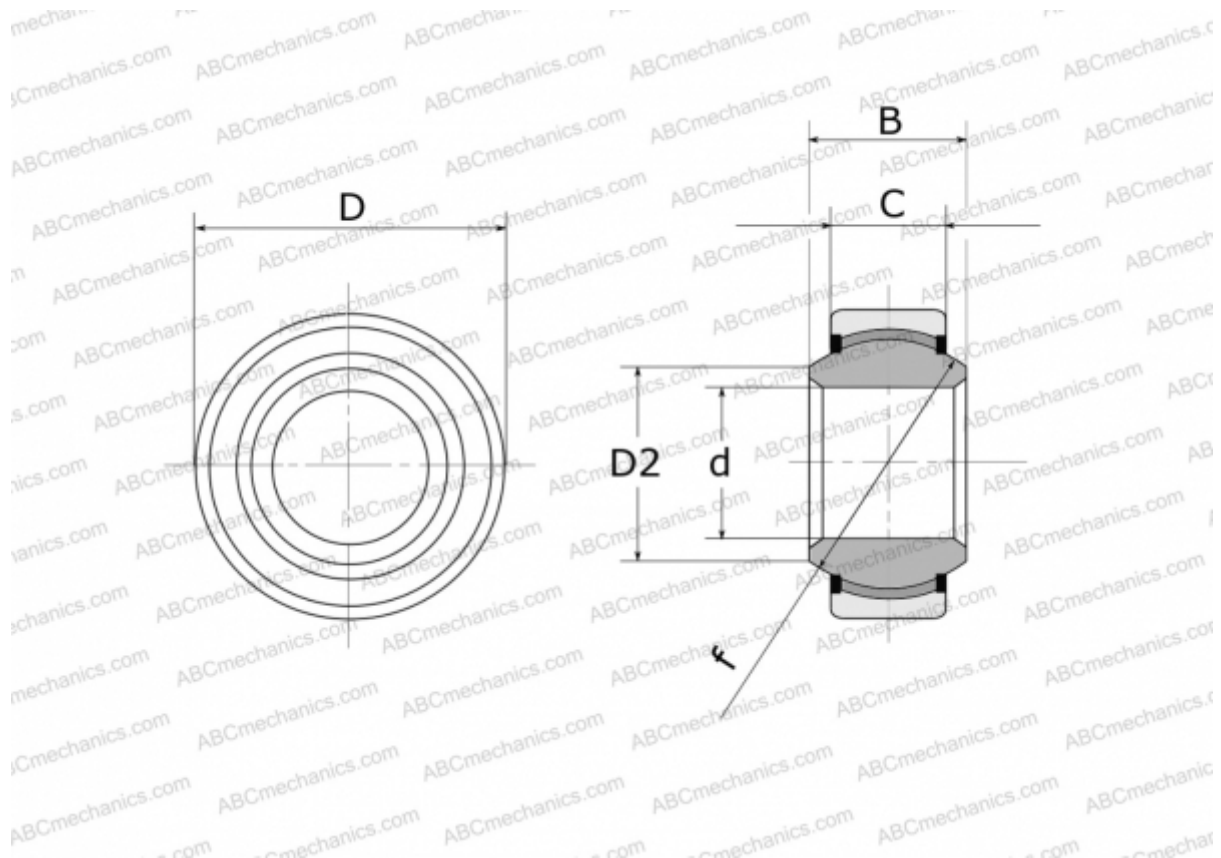

Technical specification

DIMENSIONS, MM

d	35,000
D	62,000
D2	39,700
B	35,000
f	53,000
C	22,000

WEIGHT, KG 0,408

MANUFACTURER [FLURO](#)