

GE 4 E FLURO

Spherical plain bearings

TYPE: Plain bearings, Spherical plain bearings and rod ends, Radial spherical plain bearings, Requiring maintenance, Series GE..E (FLURO)

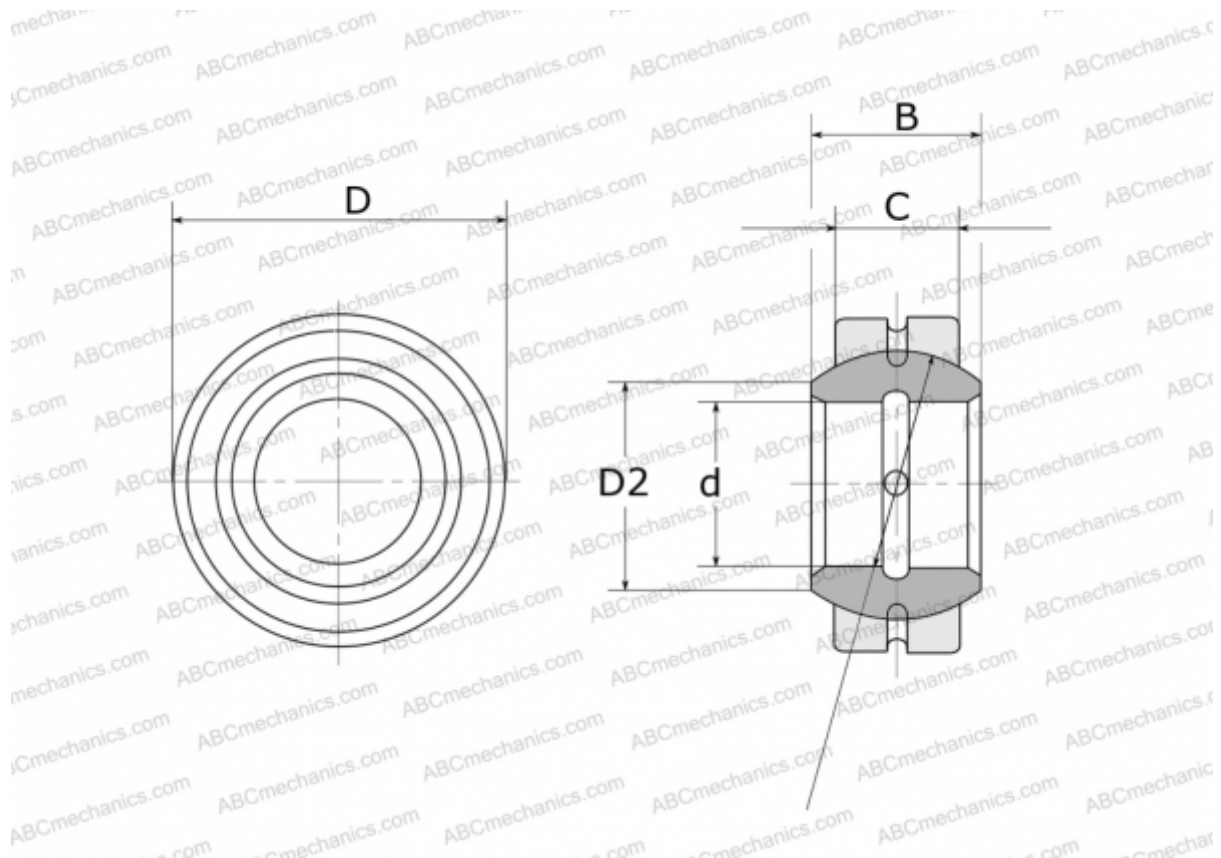

Technical specification

DIMENSIONS, MM

d	4,000
D	12,000
D2	6,000
B	5,000
f	8,000
C	3,000

WEIGHT, KG 0,003

MANUFACTURER [FLURO](#)