

GE 17 E FLURO

Spherical plain bearings

TYPE: Plain bearings, Spherical plain bearings and rod ends, Radial spherical plain bearings, Requiring maintenance, Series GE..E (FLURO)

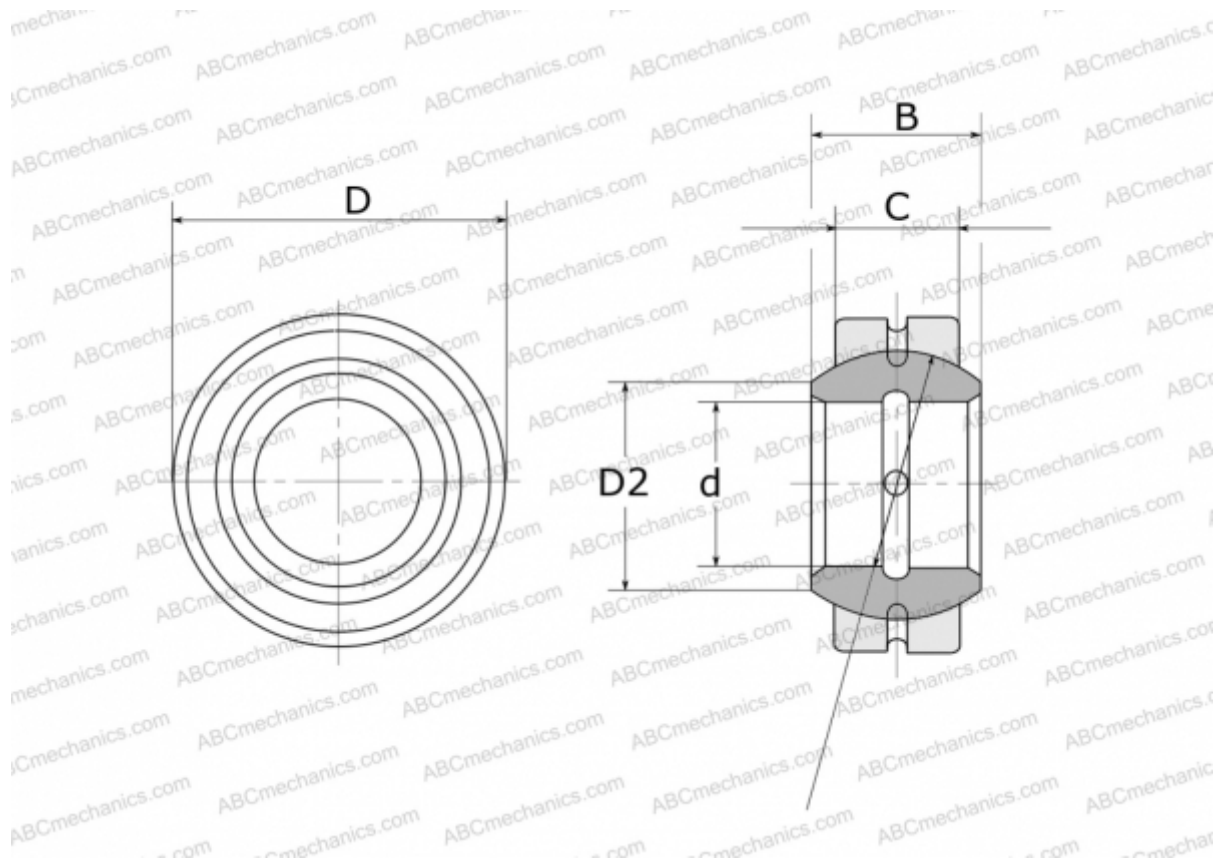

Technical specification

DIMENSIONS, MM

d	17,000
D	30,000
D2	20,700
B	14,000
f	25,000
C	10,000

WEIGHT, KG 0,040

MANUFACTURER [FLURO](#)