

GE 35 E FLURO

Spherical plain bearings

TYPE: Plain bearings, Spherical plain bearings and rod ends, Radial spherical plain bearings, Requiring maintenance, Series GE..E (FLURO)

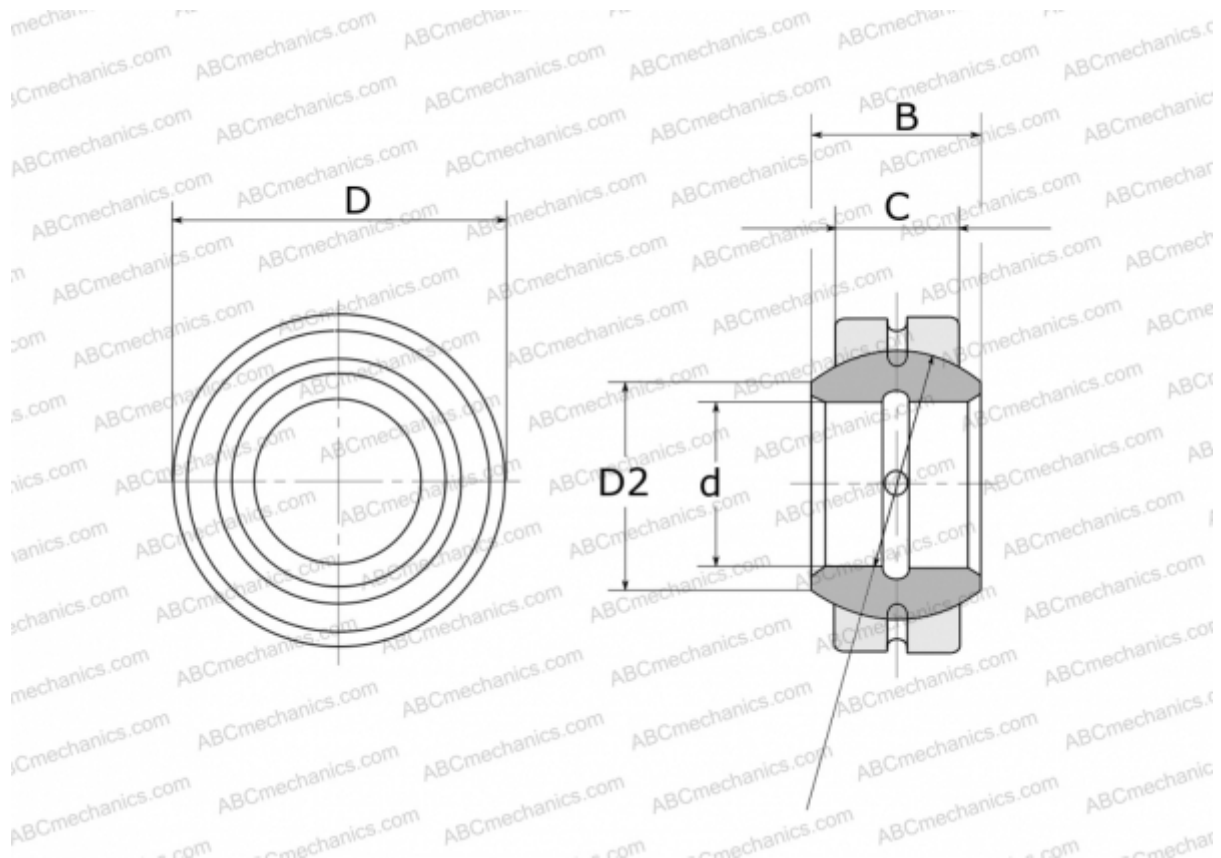

Technical specification

DIMENSIONS, MM

d	35,000
D	55,000
D2	39,700
B	25,000
f	47,000
C	20,000

WEIGHT, KG 0,228

MANUFACTURER [FLURO](#)