

## GE 55 E FLURO

Spherical plain bearings

TYPE: Plain bearings, Spherical plain bearings and rod ends, Radial spherical plain bearings, Requiring maintenance, Series GE..E (FLURO)

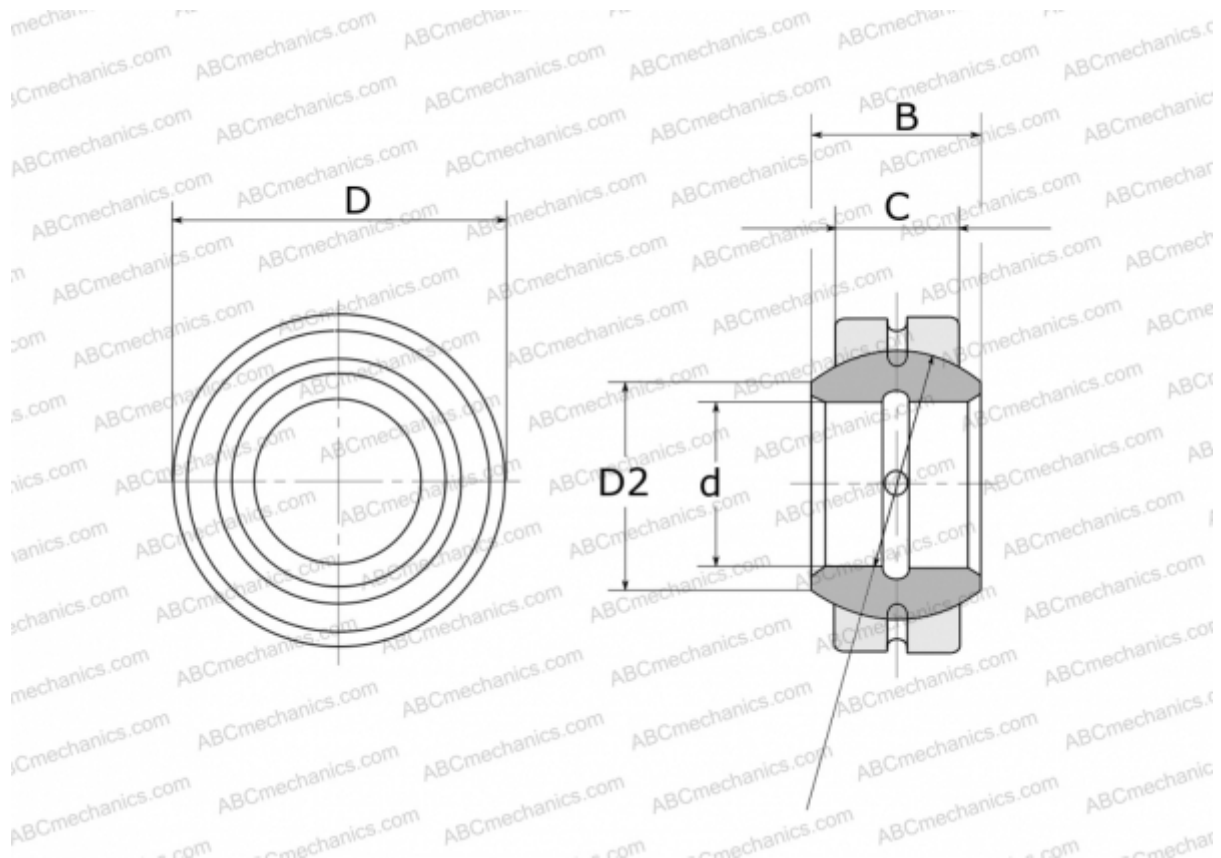

### Technical specification

#### DIMENSIONS, MM

d	55,000
D	85,000
D2	62,300
B	40,000
f	74,000
C	32,000

**WEIGHT, KG** 0,864

**MANUFACTURER** [FLURO](#)