

GE 180 E FLURO

Spherical plain bearings

TYPE: Plain bearings, Spherical plain bearings and rod ends, Radial spherical plain bearings, Requiring maintenance, Series GE..E (FLURO)

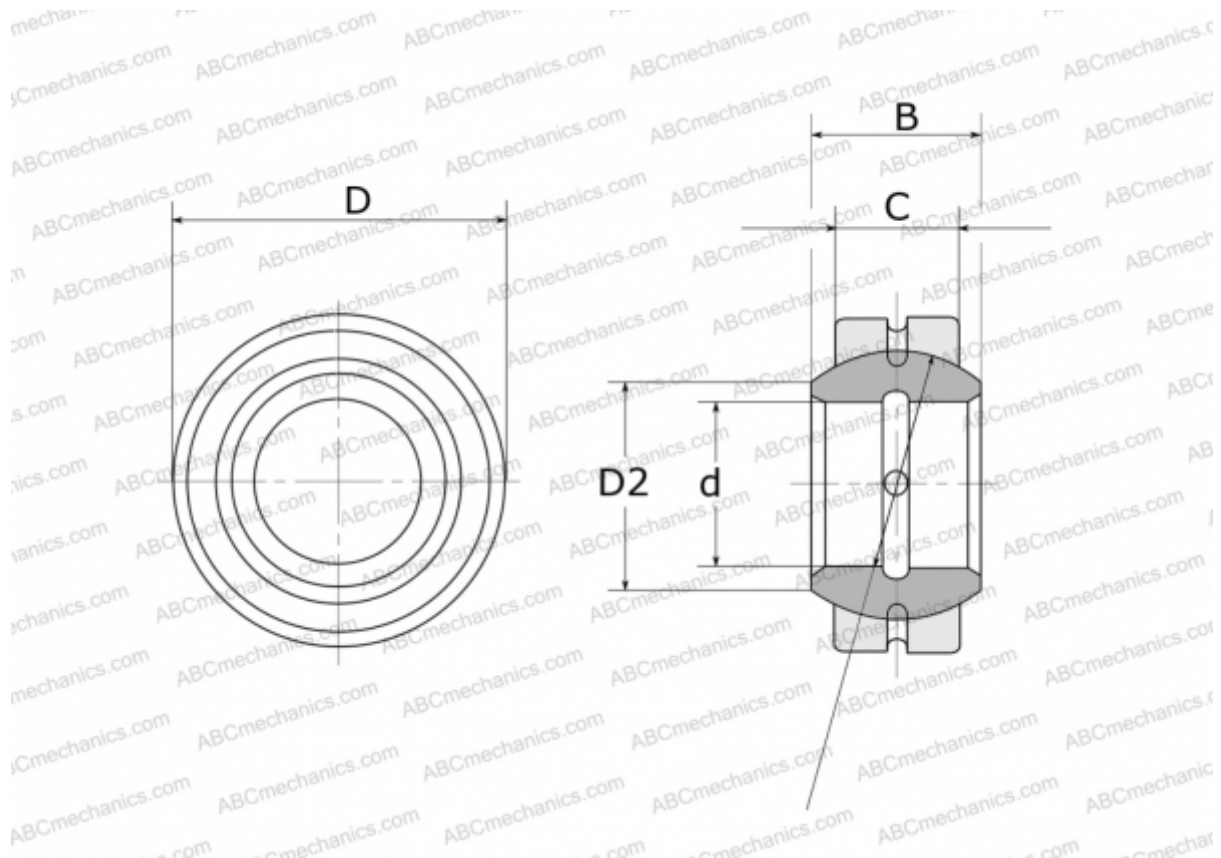

Technical specification

DIMENSIONS, MM

d	180,000
D	260,000
D2	198,900
B	105,000
f	225,000
C	80,000

WEIGHT, KG 18,500

MANUFACTURER [FLURO](#)