

GE 15 LO FLURO

Spherical plain bearings

TYPE: Plain bearings, Spherical plain bearings and rod ends, Radial spherical plain bearings, Requiring maintenance, Series GE...LO (FLURO)

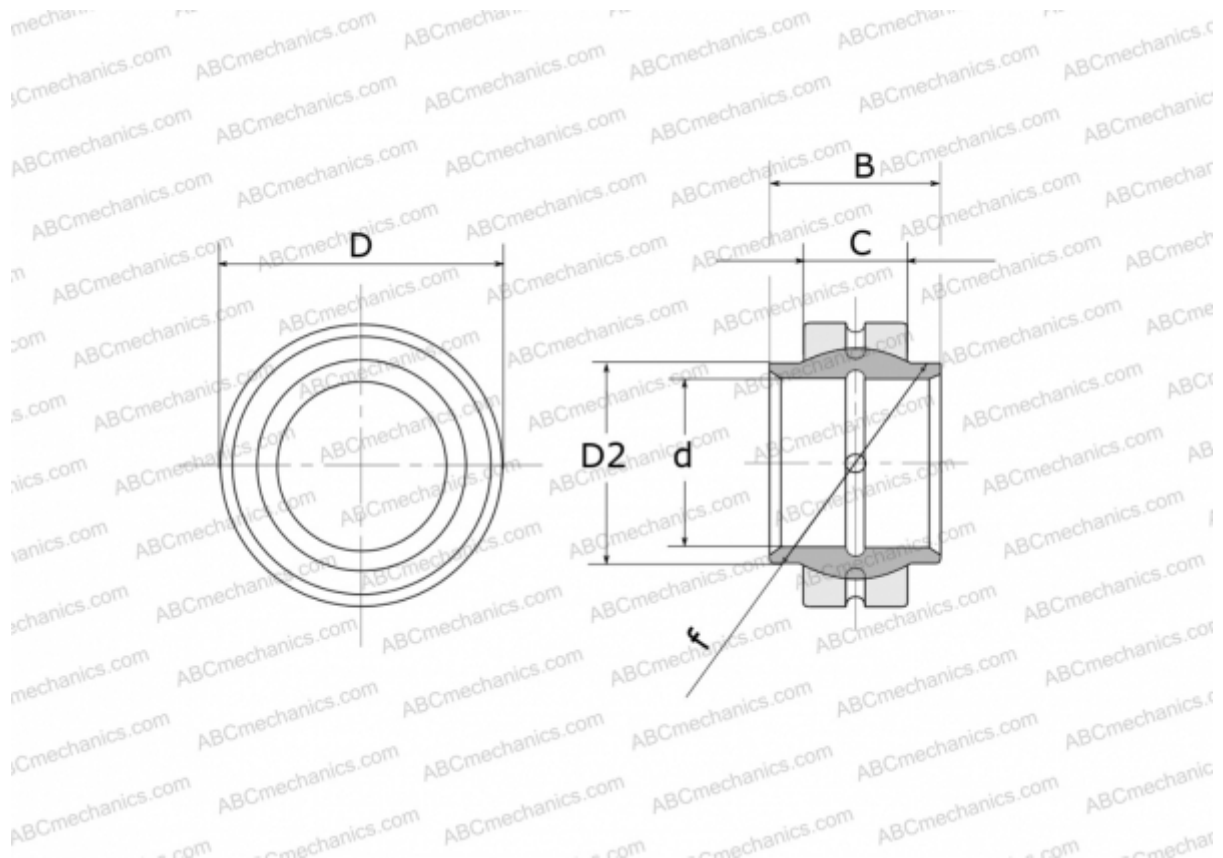

Technical specification

DIMENSIONS, MM

d	15,000
D	26,000
D2	18,500
B	15,000
f	22,000
C	9,000

WEIGHT, KG 0,028

MANUFACTURER [FLURO](#)