

GE 16 LO FLURO

Spherical plain bearings

TYPE: Plain bearings, Spherical plain bearings and rod ends, Radial spherical plain bearings, Requiring maintenance, Series GE...LO (FLURO)

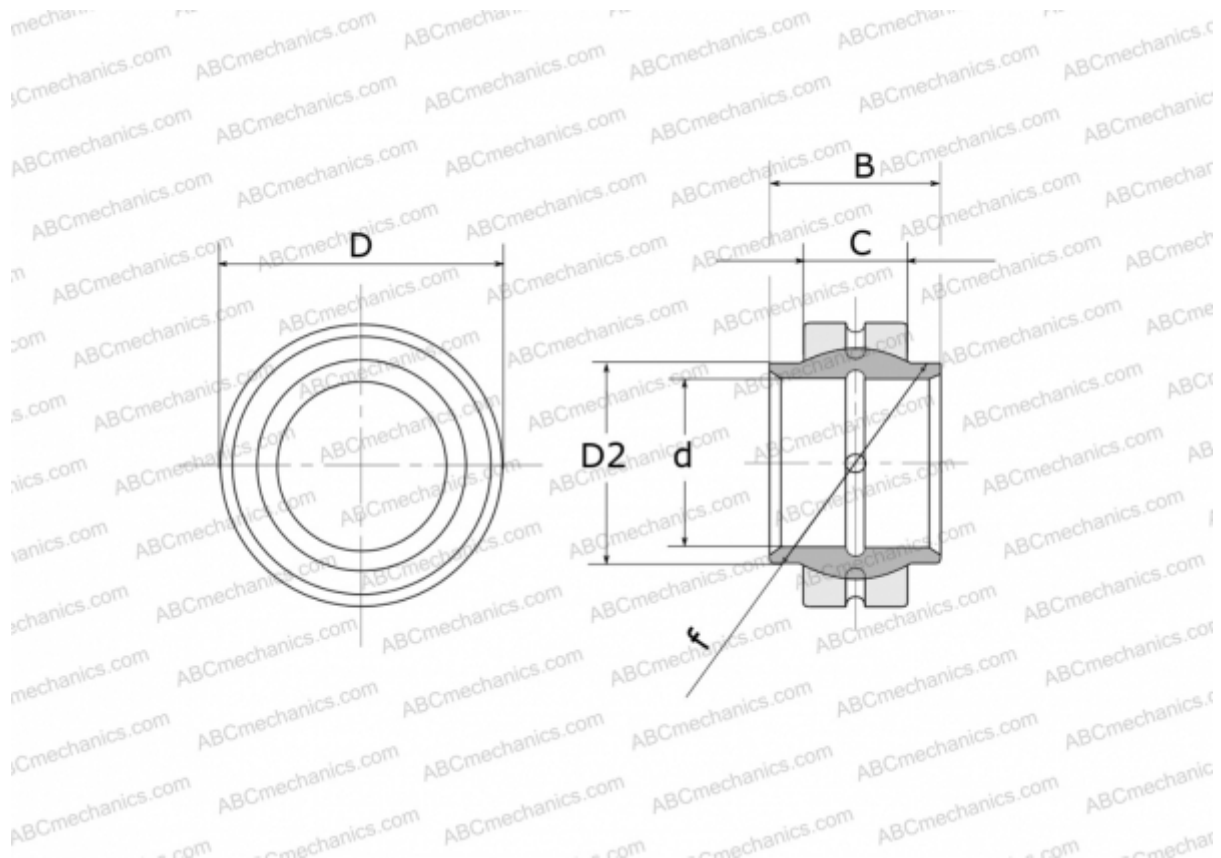

Technical specification

DIMENSIONS, MM

d	16,000
D	28,000
D2	20,000
B	16,000
f	23,000
C	9,000

WEIGHT, KG 0,034

MANUFACTURER [FLURO](#)