

GE 32 LO FLURO

Spherical plain bearings

TYPE: Plain bearings, Spherical plain bearings and rod ends, Radial spherical plain bearings, Requiring maintenance, Series GE...LO (FLURO)

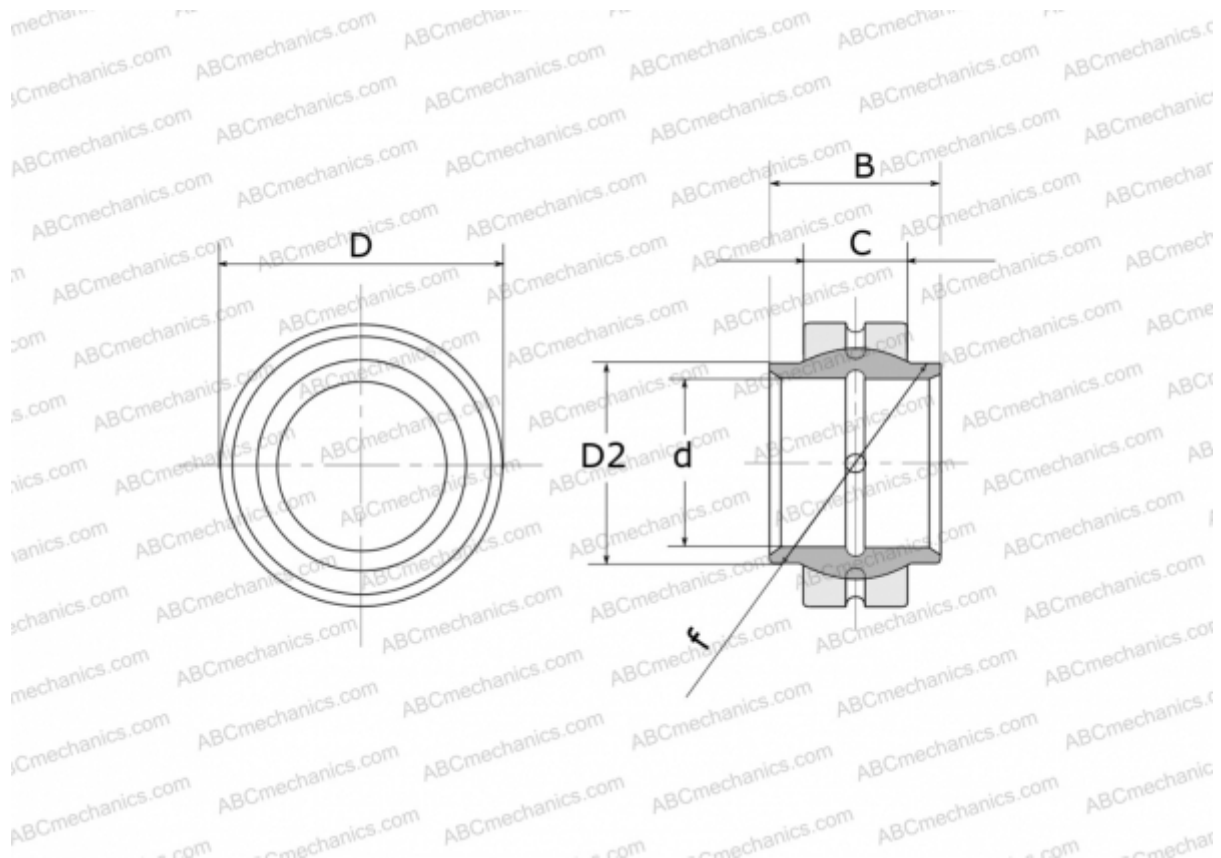

Technical specification

DIMENSIONS, MM

d	32,000
D	52,000
D2	37,000
B	32,000
f	43,000
C	18,000

WEIGHT, KG 0,207

MANUFACTURER [FLURO](#)