

GE 45 LO FLURO

Spherical plain bearings

TYPE: Plain bearings, Spherical plain bearings and rod ends, Radial spherical plain bearings, Requiring maintenance, Series GE...LO (FLURO)

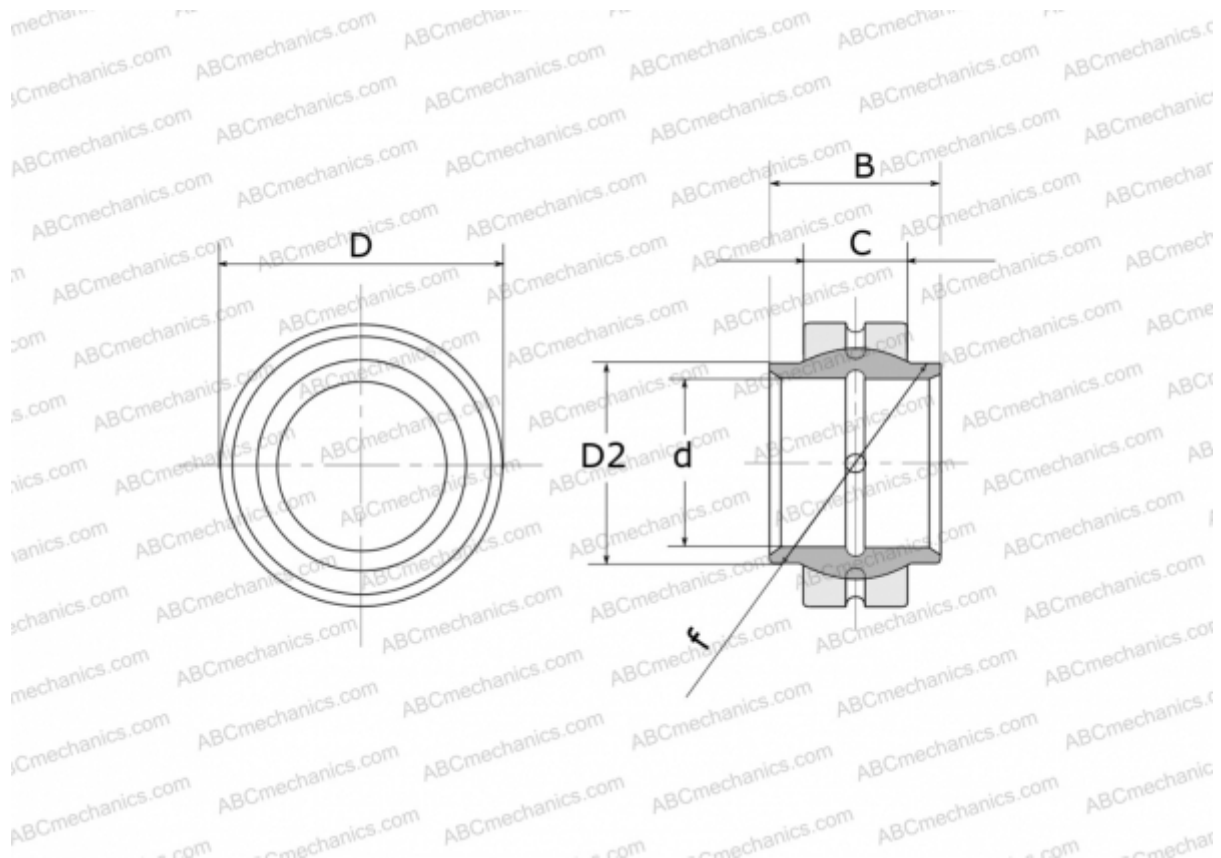

Technical specification

DIMENSIONS, MM

d	45,000
D	68,000
D2	52,000
B	45,000
f	60,000
C	25,000

WEIGHT, KG 0,468

MANUFACTURER [FLURO](#)