

## GE 63 LO FLURO

Spherical plain bearings

TYPE: Plain bearings, Spherical plain bearings and rod ends, Radial spherical plain bearings, Requiring maintenance, Series GE...LO (FLURO)

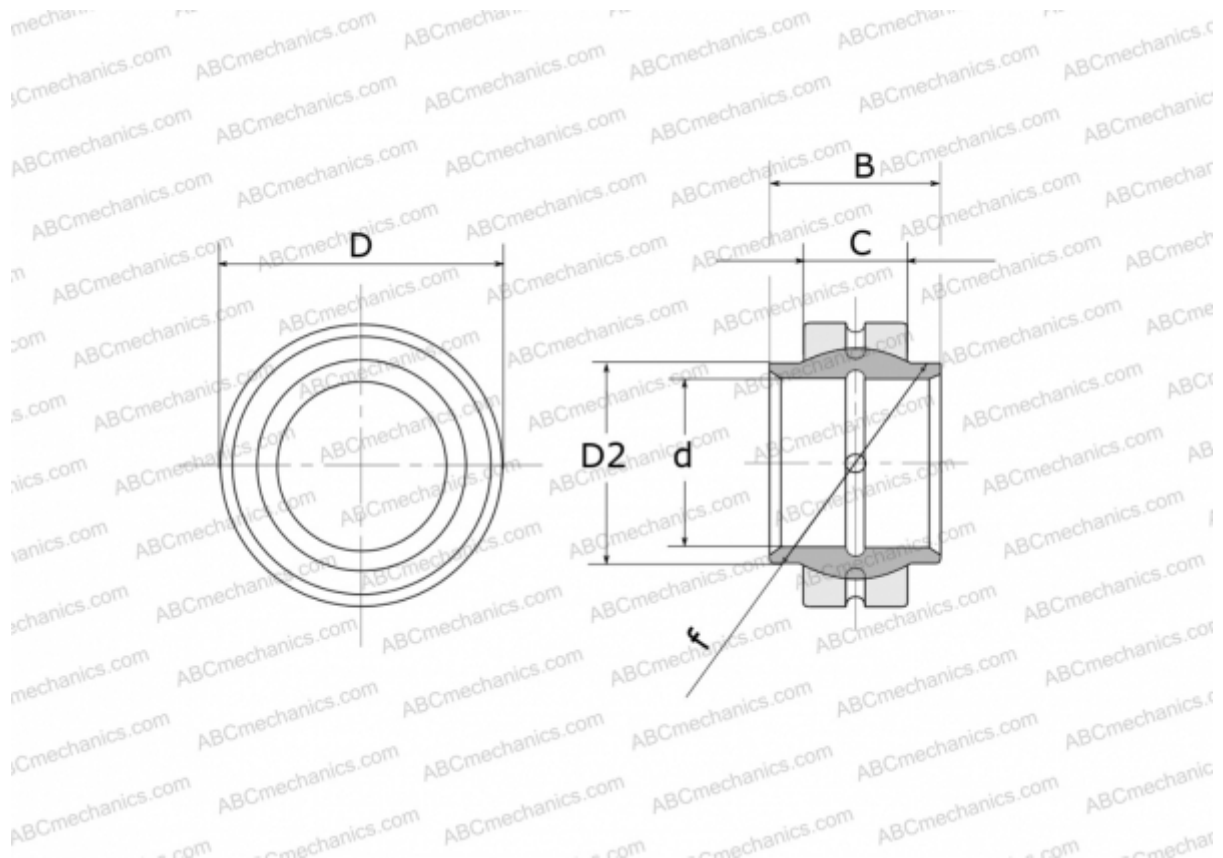

### Technical specification

#### DIMENSIONS, MM

d	63,000
D	95,000
D2	71,500
B	63,000
f	83,000
C	36,000

**WEIGHT, KG** 1,270

**MANUFACTURER** [FLURO](#)