

GE 70 LO FLURO

Spherical plain bearings

TYPE: Plain bearings, Spherical plain bearings and rod ends, Radial spherical plain bearings, Requiring maintenance, Series GE...LO (FLURO)

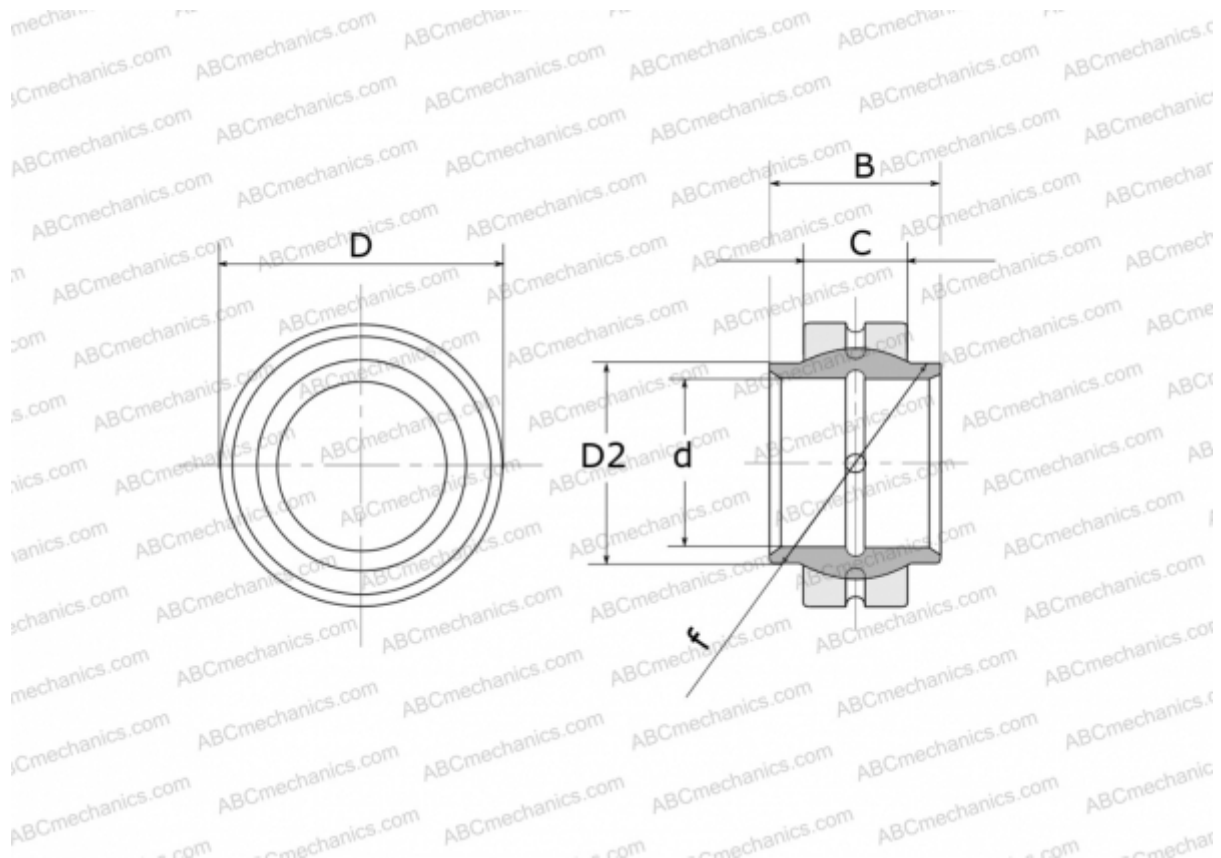

Technical specification

DIMENSIONS, MM

d	70,000
D	105,000
D2	79,000
B	70,000
f	92,000
C	40,000

WEIGHT, KG 1,690

MANUFACTURER [FLURO](#)