

GE 90 LO FLURO

Spherical plain bearings

TYPE: Plain bearings, Spherical plain bearings and rod ends, Radial spherical plain bearings, Requiring maintenance, Series GE...LO (FLURO)

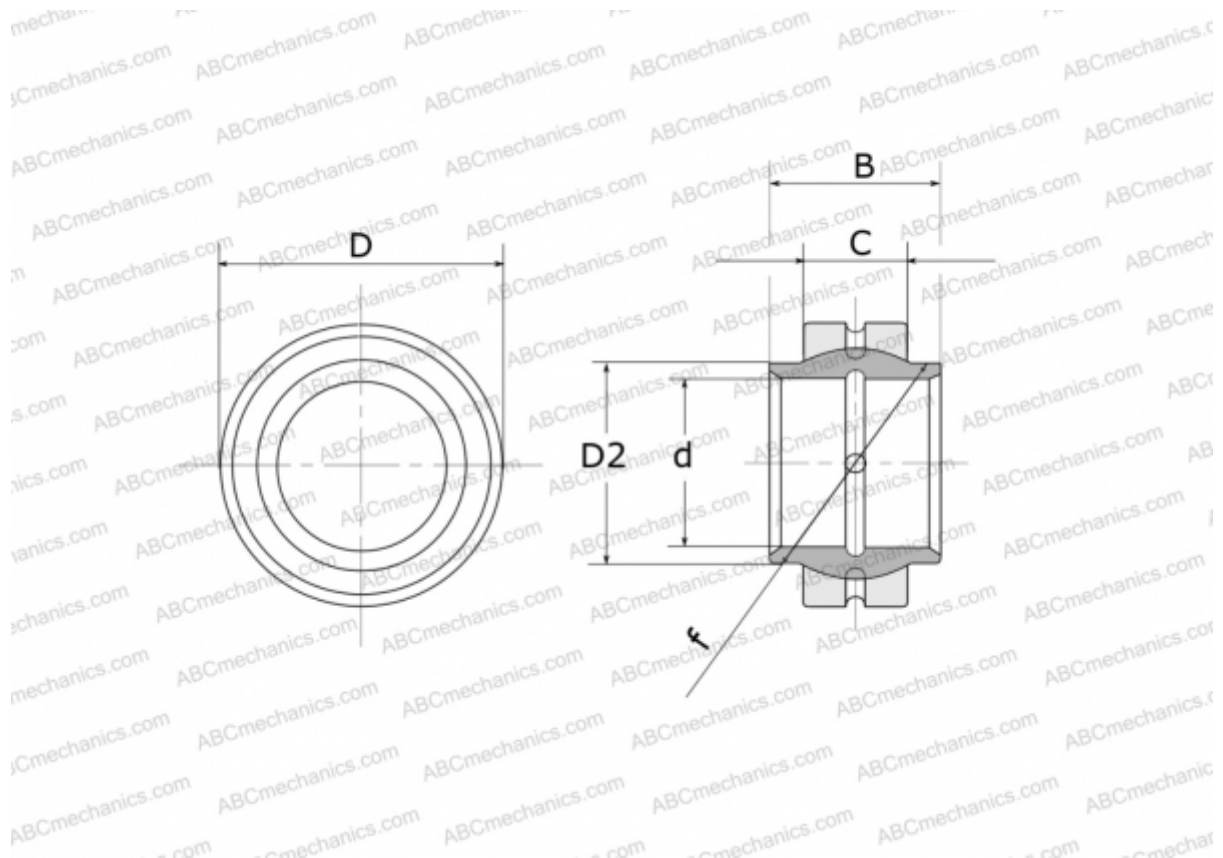

Technical specification

DIMENSIONS, MM

d	90,000
D	130,000
D2	99,000
B	90,000
f	115,000
C	50,000

WEIGHT, KG 3,040

MANUFACTURER [FLURO](#)